

PELLET STOVE

KIRA - VYDA



CONTENTS

Introduction and who the manual is for	3
Safety information	4
Dimensions	5
Technical data	7
Unpacking	8
Installation	10
Fitting the cladding Kira	9
Fitting the cladding Vyda	20
Instructions for use	26
Maintenance	36
Troubleshooting	41

Edition in English translated from the original version in Italian

The undersigned EDILKAMIN S.p.A., with registered office in Via Vincenzo Monti 47 - 20123 Milan (Italy) - Tax ID Code and VAT number 00192220192

Hereby declares, under its sole responsibility, that:
The pellet stove mentioned below complies with EU Regulation 305/2011 and the harmonised EU standard EN 14785:2006

PELLET STOVE, trade name EDILKAMIN, model KIRA - VYDA

SERIAL NO.: Rating plate reference
KIRA - VYDA: Performance declaration: (DoP - EK No. 160):

Moreover, the company hereby declares that:
the KIRA - VYDA wood pellet stove satisfies the requirements of the following European directives:
2014/35/EU - Low Voltage Directive
2014/30/EU - Electromagnetic Compatibility Directive

Dear Sir/Madam

We thank you for and congratulate you on choosing our product. Before using it, we would ask you to read this manual carefully, so that you can make the most of all its functions in total safety.

This manual is an integral part of the product. We ask you to keep it for the entire lifetime of the product. If you lose it, you can request a copy from your dealer or download it from www.edilkamin.com.

Readers of the manual

This manual is addressed to:

- those who use the product at home ("USER");
- the technician who will install the product ("INSTALLER")

The target person of each page is indicated in a band at the bottom of the page (USER or INSTALLER).

General information

After unpacking the product, check the condition and completeness of the contents.

In the event of error, immediately contact the retailer where the purchase was made, providing him with a copy of the warranty booklet and sales receipt.

The appliance must be installed and operated in compliance with local and national law and European regulations. For the installation, and for anything not specifically indicated in the manual, observe local regulations.

The diagrams provided in this manual are for illustration purposes only: they do not always strictly refer to your specific model, and are not binding in any way.

Product identification and warranty.

The product is uniquely identified by a number, the "counterfoil", which is indicated on the warranty certificate.

Please keep:

- the warranty certificate accompanying the product
- the purchase receipt given to you by the retailer
- the declaration of conformity given to you by the installer.

The warranty conditions are given in the warranty certificate accompanying the product.

First ignition is required, in Italy, by an authorised technician in accordance with UNI 10683, and is recommended in all countries to ensure best results from the product.

This consists of:

- checking the installation documents (declaration of conformity) and the quality of the installation itself
- calibrating the product to suit its actual application
- providing explanations to the end user and issuing the complementary documentation (first ignition - commissioning certificate)

Having the appliance commissioned properly ensures that it will operate to best effect and in complete safety.

First ignition is required for activation of the Edilkamin manufacturer warranty. The warranty is only valid in the country where the product was bought.

If the appliance is not commissioned by an authorised technician, Edilkamin will not provide warranty service. See the warranty booklet for details. The above terms do not affect the dealer's legal responsibility for the legal warranty.

The warranty, however, covers only demonstrable manufacturing defects and not, for instance, problems resulting from improper installation or calibration.

MEANING OF SYMBOLS

In some parts of the manual the following symbols are used:



PLEASE NOTE:

carefully read and understand the message in question, since failure to follow the instructions in it could cause serious damage to the product and put the safety of those using it at risk.



INFORMATION:

failure to comply with these requirements will compromise product use.



OPERATING SEQUENCE:

follow the instructions for the operations described.

- The product is not designed for use by people, including children, with limited physical, sensory and mental abilities.
- The appliance is not designed for cooking purposes.
- The appliance is designed to burn UNI EN ISO 17225-2 category A1 wood pellets, in the amounts and manner described in this manual.
- The appliance is designed for indoor use and in areas with normal humidity conditions.
- Keep the product in a dry place out of the weather.
- For the legal and company warranties, refer to the warranty certificate inside the product: specifically, neither Edilkamin nor the retailer are liable for damage resulting from incorrect installation or maintenance.

Safety risks may be caused by:

- Installation in non-suitable settings, in particular those that are subject to fire risks. **DO NOT INSTALL THE PRODUCT IN AREAS SUBJECT TO THE RISK OF FIRE.**
- Contact with fire and hot parts (e.g. glass panel and pipes). **DO NOT TOUCH HOT PARTS** and, when the stove is switched off and still hot, always wear the glove supplied.
- Contact with live electrical equipment (internal). **DO NOT ACCESS THE INTERNAL ELECTRICAL EQUIPMENT WHILE THE APPLIANCE IS POWERED ON.** Electrocutation hazard.
- Use of improper ignition aids (e.g. alcohol). **DO NOT IGNITE OR BOOST THE FLAME WITH FLUID SPRAYS OR A FLAME TORCH.** Serious risk of burns, damage and injury.
- Use of fuel other than wood pellets. **DO NOT BURN WASTE MATTER, PLASTIC OR MATERIALS OTHER THAN WOOD PELLETS IN THE COMBUSTION CHAMBER.** The product may become soiled, the flue may catch fire, and environmental damage may ensue.
- Cleaning the combustion chamber when hot. **DO NOT CLEAN WITH A VACUUM CLEANER WHEN HOT.** You could damage the vacuum-cleaner and risk the emission of smoke in the room.
- Cleaning the smoke duct with cleaning products. **DO NOT CLEAN THE PRODUCT WITH FLAMMABLE PRODUCTS.** Risk of fire or blowback.
- Cleaning the glass pane while hot or with unsuitable cleaning products. **DO NOT CLEAN HOT GLASS WITH WATER. ONLY USE RECOMMENDED GLASS CLEANING PRODUCTS.** Risk of cracking and permanent, irreparable damage to the glass.
- The storage of flammable materials at a distance which is less than the safe distances listed in this manual. **DO NOT PLACE LAUNDRY ON THE APPLIANCE. DO NOT PLACE DRYING RACKS WITHIN THE SAFETY CLEARANCE.** Keep flammable fluids away from the appliance. Fire hazard.
- Blocking the aeration vents and air intakes in the room. **DO NOT BLOCK THE AERATION VENTS OR FLUE.** Risk of smoke returning into the room with consequent damage and injury.
- Use of the product as a support or ladder. **DO NOT CLIMB ONTO THE PRODUCT OR USE IT AS A SUPPORT.** Risk of damage and injury.
- Use of the stove with the combustion chamber open. **DO NOT USE THE PRODUCT WITH ITS DOOR OPEN.**
- Incandescent material may come out from the open door. **DO NOT** throw incandescent material outside the appliance. Fire hazard.
- Use of water in case of fire. **CALL THE AUTHORITIES** if a fire breaks out.
- If you have doubts, please do not take any action, but contact the retailer or the installer.

For reasons of safety, read the user instructions included in this manual.

KIRA - DIMENSIONS (cm)

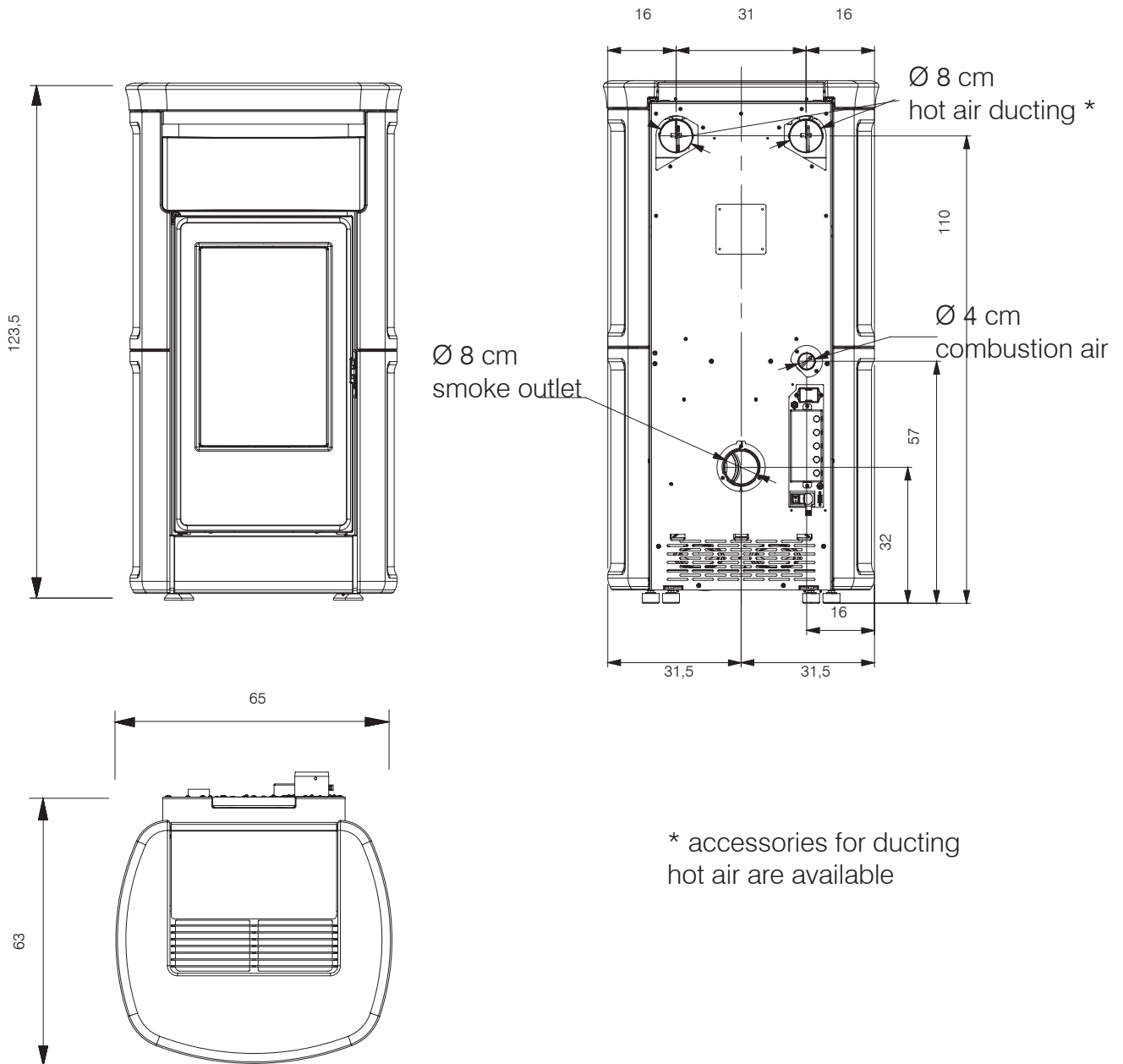

* accessories for ducting hot air are available

VYDA - DIMENSIONS (cm)

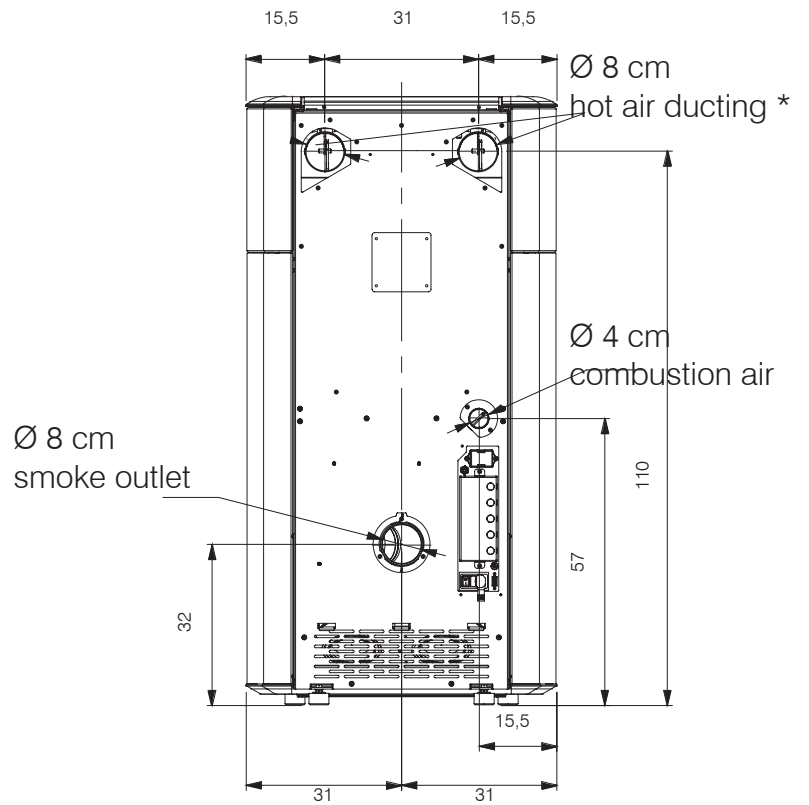
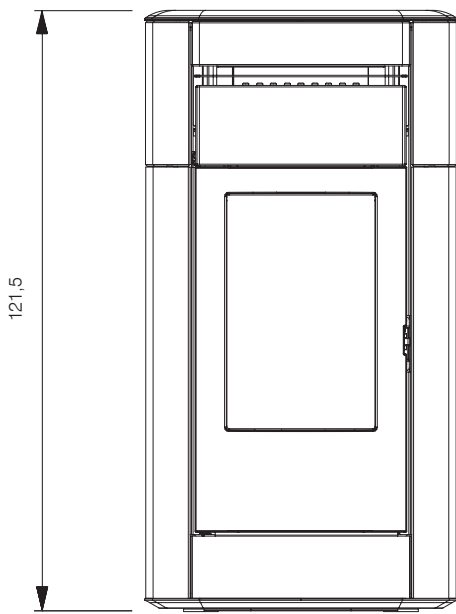

* accessories for ducting hot air are available

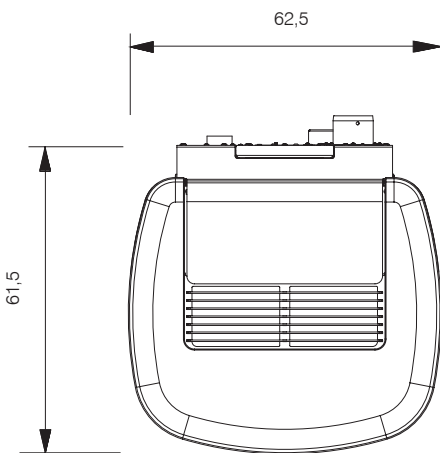

TECHNICAL DATA EN 14785			
	KIRA - VYDA		
	Nominal power	Reduced power	
Available power	14,3	4,2	kW
Efficiency	90	92,1	%
CO emissions at 13% O ₂	0,016	0,037	%
Fumes temperature	159	93	°C
Fuel consumption	3,3	1	kg/h
Tank capacity	30		kg
Draw	12	10	Pa
Autonomy	9	30	hours
Heatable volume *	375		m ³
Fumes outlet diameter (male)	80		mm
Air intake diameter (male)	40		mm
Ducting diameter	80		mm
Weight with packaging	180		kg

* Il volume riscaldabile è calcolato con una richiesta di calore di 33 Kcal/m³ ora

TECHNICAL DATA FOR RATING THE FLUE			
which must in any case satisfy the requirements of this sheet and the installation instructions			
	Nominal power		
	Reduced power		
Fumes temperature at smoke outlet	220	130	°C
Minimum draw	0,01		Pa
Fumes flow rate	7	4	g/s

ELECTRICAL SPECIFICATIONS	
Power supply	230 Vac +/- 10% 50 Hz
Mean absorbed power	35-190 W
Power absorption during ignition	520 W
Remote control frequency (provided)	2,4 GHz
Protection rating	Fusibile 4 AT, 250 Vac 5x20

The above data is for guidance only and was measured during certification by a notified body. EDILKAMIN s.p.a. reserves the right to modify the product without notification in the interests of improvement.

PREPARATION AND UNPACKING

The packaging materials are neither toxic nor noxious and do not require special disposal.

The user is responsible for storing, disposing of and recycling them in a regulatory fashion.



Always move the stove in an upright position with suitable equipment and in observance of safety regulations.

Do not turn the package over, and handle all parts requiring installation with care.

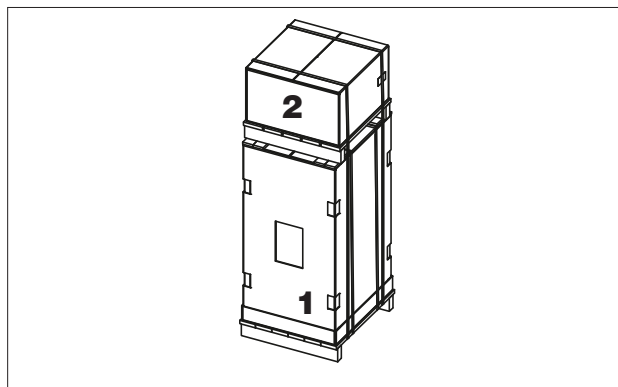
**PACKAGING** (further information in the paragraph on linings)

The delivery consists of two packages:

- one **(1)** with the structure of the stove
- one **(2)** with the ceramic or stone cladding

In the stove package you will find:

- warranty certificate,
- glove,
- this manual,
- remote control;
- power cable,
- small parts for installing the lining * (further details on the following page),
- grille of the top,
- protective lever (removable handle) for opening the combustion chamber door.

The metal grille of the top is contained in package (1) with the stove, provided with the small parts for its installation (three M4 screws for the ceramic parts and M6 for the stone parts, washers and rubber buffers to be applied on top of the grille)

* Other small parts (for Vyda and Kira)

- M4 screws with washers for fixing the ceramic parts
- M5 screws with washers for the ceramic sides of Kira H
- M6 screws for fixing the stone parts
- cable glands for the terminal board on the rear

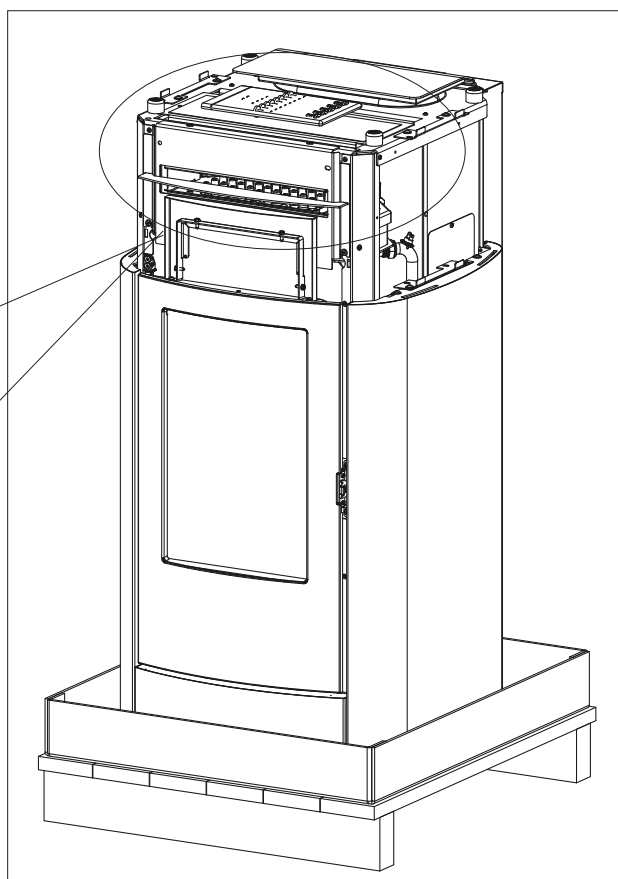
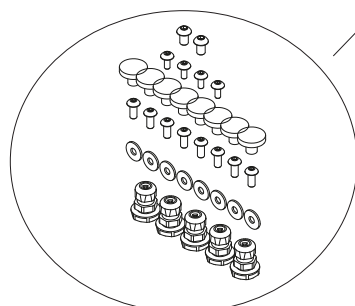
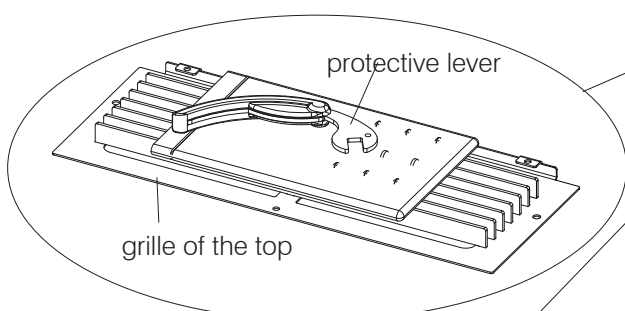

On the top of the stove there are the components described above

TO REMOVE KIRA FROM THE PALLET

To remove the stove from the pallet you must (see figures below corresponding to instructions):

1. remove the two brackets (screwed) on the front
2. remove the two brackets (screwed) on the rear of the stove

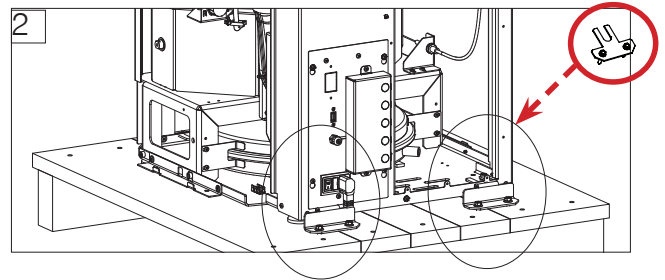
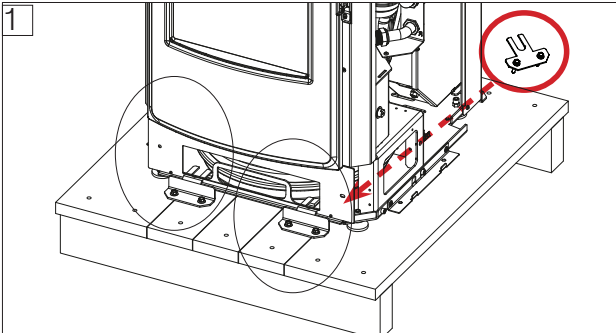
**TO REMOVE VYDA FROM THE PALLET**

To remove the stove from the pallet you must (see figures below corresponding to instructions):

1. open the combustion chamber door; undo the two screws holding the bottom front panel and remove it to access the two screws which fix the product to the pallet
2. remove the two brackets (screwed) on the rear of the stove

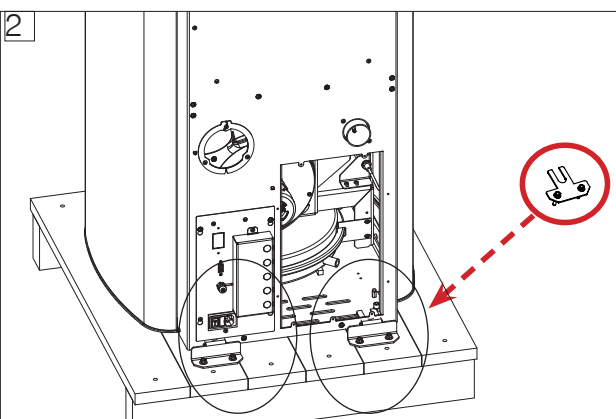
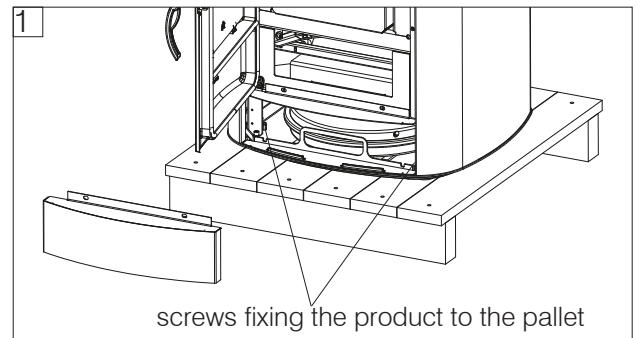
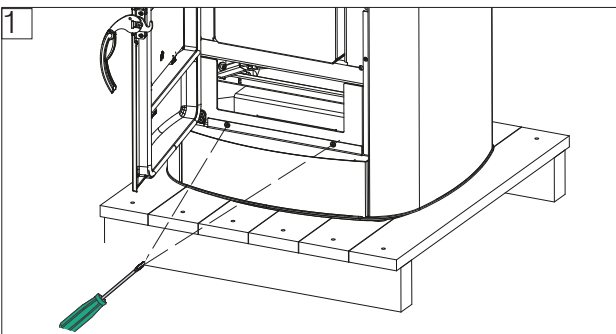

**THE DRAWINGS ARE FOR GUIDANCE ONLY,
USEFUL FOR THE INSTALLATION, BUT THEY
MAY NOT REFER TO THE SPECIFIC MODEL.**



DO NOT TRY TO REMOVE THE PRODUCT FROM THE PALLET WITHOUT HAVING OPENED THE COMBUSTION CHAMBER DOOR AND UNDONE THE SCREWS WHICH FIX IT TO THE PALLET

REMARKS ON INSTALLATION

Note that:

- installation must be carried out by authorised technical personnel;
- The appliance must be installed and operated in compliance with local and national law and European regulations. The applicable Italian regulation is UNI 10683;
- If installed in a condominium, the appliance must be approved by the administrator.

We give some general instructions below, however these do not obviate the need to comply with local regulations and do not affect the installer's liability for the installation.

Checking the suitability of the installation space

- The room must have a volume of at least 30 m³.
- The floor must be able to bear the weight of the product and its accessories.
- Level the appliance.
- The appliance may not be installed in a bedroom, bathroom or in the same room as other equipment which draws air for combustion from the room itself, or in any area with an explosive atmosphere. Any extraction fans operating in the same room or area as the product, may affect its draw.
- In Italy, check the compatibility pursuant to UNI 10683 and UNI 7129 in the presence of gas fired products.

Protection from heat and safety clearances

The surfaces of the building adjacent to the product must be protected against overheating.

The insulation to be used will depend on the type of surface in question.

The appliance must be installed in accordance with the following safety instructions:

- minimum clearance at the sides and rear of 20 cm from flammable materials.

- no flammable materials may be kept closer to the front of the appliance than 80 cm.

If connected to a wooden or otherwise flammable wall, the flue must be insulated appropriately.

If installed on a flammable or combustible floor, or one incapable of bearing its load, use steel or glass plates under the stove to distribute the load.

Contact the retailer for such optional equipment

Positioning the product

The product is designed to operate in all climatic conditions. In special circumstances, such as strong wind, its safety equipment may switch the appliance off.

Contact the authorised Edilkamin Technical Assistance Centre.

FLUE SYSTEM

(Smoke duct, flue and chimney pot)

This chapter has been drawn up pursuant to European regulations EN 13384, EN 1443, EN 1856 and EN 1457. The installer must observe both these and any other local regulations. This manual does not in any way substitute such regulations.

The product must be connected to a flue system which ensures that the smoke produced by combustion are discharged in complete safety.

Before positioning the appliance, the installer must check that the flue is suitable.

SMOKE DUCT, FLUE

The smoke duct (which connects the combustion chamber's smoke outlet with the flue) and the flue itself must, among other regulatory requirements:

- receive the smoke from a single product (the outlets of multiple appliances cannot be conveyed into a single flue)
- be routed vertically for the most part
- have no downwards sloping sections
- preferably have a circular internal cross section, or with a ratio of the sides of less than 1.5
- terminate at roof level with a proper chimney pot: the flue may not discharge directly on the wall or into an enclosed space, even if the space in question is open to the sky
- be made of material rated in fire reaction class A1 as per UNI EN 13501 or analogous national regulations

- be certified, with a chimney plate if metal
- be of uniform cross section or vary in cross section only immediately after the outlet, not at some mid point of its length.

THE SMOKE DUCT

Further to the general requirements for the smoke duct and flue, the smoke duct:

- may not be made of flexible metal material
- must be insulated, if routed through unheated areas or outdoors
- must not be routed through rooms where the installation of combustion heat generators is prohibited, there is risk of fire, or which cannot be inspected
- must enable the recovery of soot and be open for inspection
- have at most 3 bends with a maximum angle of 90°
- must have a single horizontal section with a length of no more than 3 metres, depending on the draw. Note, in any case, that long sections promote the accumulation of dirt and are harder to keep clean.

THE FLUE:

Further to the general prescriptions for the smoke duct and flue, the flue:

- must serve solely to discharge smoke
- must be correctly sized to satisfy the requirements of smoke discharge (EN 13384-1)
- should preferably be insulated, in steel with a circular internal section. If rectangular, the corners must have a radius of not less than 20 mm, with a ratio of the internal dimensions of <1.5
- must normally be at least 1.5 metres in vertical length
- must have a constant cross section
- must be waterproof and thermally insulated to ensure a good draw
- must preferably have a collection chamber for non-combusted matter and any condensation.
- if pre-existing, must be clean, to prevent fire hazards
- in general, we recommend fitting a tube inside the existing masonry chimney if its diameter is greater than 150 mm.

INTUBATED SYSTEM:

Further to the general prescriptions for the smoke duct and flue, the intubated system:

- must operate in negative pressure
- must be open to inspection
- must observe local regulations.

THE CHIMNEY POT

- must be windproof
- must have an internal cross section equivalent to that of the flue and a smoke outlet at least double that of the interior of the flue
- for dual flues (which should be spaced at least 2 m apart) the chimney pot receiving the smoke from the solid fuel appliance or that from the higher storey, must be at least 50 cm higher than the other
- it must extend beyond the back flow zone (in Italy, refer to UNI 10683 point 6.5.8.)
- it must allow for maintenance of the chimney

EXTERNAL AIR INTAKE

In general, we suggest two ways to ensure a proper flow of combustion air.

Indirect air intake

Install an air outlet at floor level with an effective surface area (net of the screen or other protections) of at least 80 cm² (10 cm in diameter).

To prevent draughts, we recommend installing the air intake behind the stove or behind a radiator.

Installing it in front of the appliance will create unpleasant draughts.

Direct air intake*

Install an air intake with effective area (net of the mesh or other protective equipment) at least equal to that of the air intake at the rear of the product.

Connect the air intake to the appliance's air intake with a tube (which may also be flexible). Increase the diameter of the pipe if it is not smooth: assess its load loss.

A maximum length of 1 metres is recommended, without bends.

The air may be drawn from an adjacent room only if:

- the flow is taken from permanent and unobstructed openings communicating with the outdoors;
- the adjacent room is never in underpressure relative to the outdoors;
- the adjacent room is not a garage, subject to fire hazard, a bathroom or bedroom;
- the adjacent room is not a shared room in the condominium.

In Italy, UNI 10683 provides that ventilation is sufficient even if a pressure difference between the outdoors and indoors of no more than 4 PA is guaranteed (UNI EN 13384-1). The installer who issues the declaration of conformity is responsible for ensuring these conditions.

*The direct connection of the air intake does not make the product airtight. It is therefore necessary to ensure an air recovery taken in the room by the product (i.e. for the glass cleaning)

Ducting of heating air

To duct the warm air exiting the rear, you will find several optional extras at your dealer's.

For Ø 6 cm ducting and with Edilkamin vents:

- adapter from Ø 8 cm to Ø 6cm
- air duct pipe (3 metres, 6 cm diameter)
- "Y" junction for ducting pipe (6 cm diameter) to deliver the output air from an outlet hole in the stove to two rooms
- various models of ducting vents (Bent, Split, Origami, Sharp).

The instructions for connecting these vents are given in the manual provided with the vents.

For Ø 8 cm ducting with Edilkamin Kit 12-12bis

- kit 12 for ducting into an adjacent room (pipe Ø 8 cm -3 m in length, B4 terminal vent; clamp)
- kit 12bis for ducting into a distant room (pipe Ø 8 cm -6 m in length, B4 terminal vent; 2 clamps; 2 wall collars)

In the "Instructions for use" paragraph, we describe the fan settings and air directions.

**CHECKING THE ELECTRICAL CONNECTIONS
(the power socket must be located in an easy to access position)**

The stove is equipped with an electrical power cord or connection to a 230V 50 Hz socket, preferably with electromagnetic switch.

Variations in voltage of more than 10% can compromise the operation of the stove.

The electrical system must be compliant; check the operation of the earth in particular.

Edilkamin is not responsible for malfunctions resulting from an improperly earthed system.

The power line must be of adequate section for the power of the appliance.

The power cable must not come into contact with the flue or other hot parts of the stove.

Power up the stove by setting its switch from 0 to 1.

There is one 4 A fuse on the socket with switch located at the rear of the stove.

HOOKING UP OPTIONAL COMPONENTS

The product is fitted with a terminal block. 5 and 6 (AUX) can be used to hook up a thermostat or other device requiring a voltage-free contact.

1	2	3	4	5	6
Only for Technical Edilkamin				AUX	

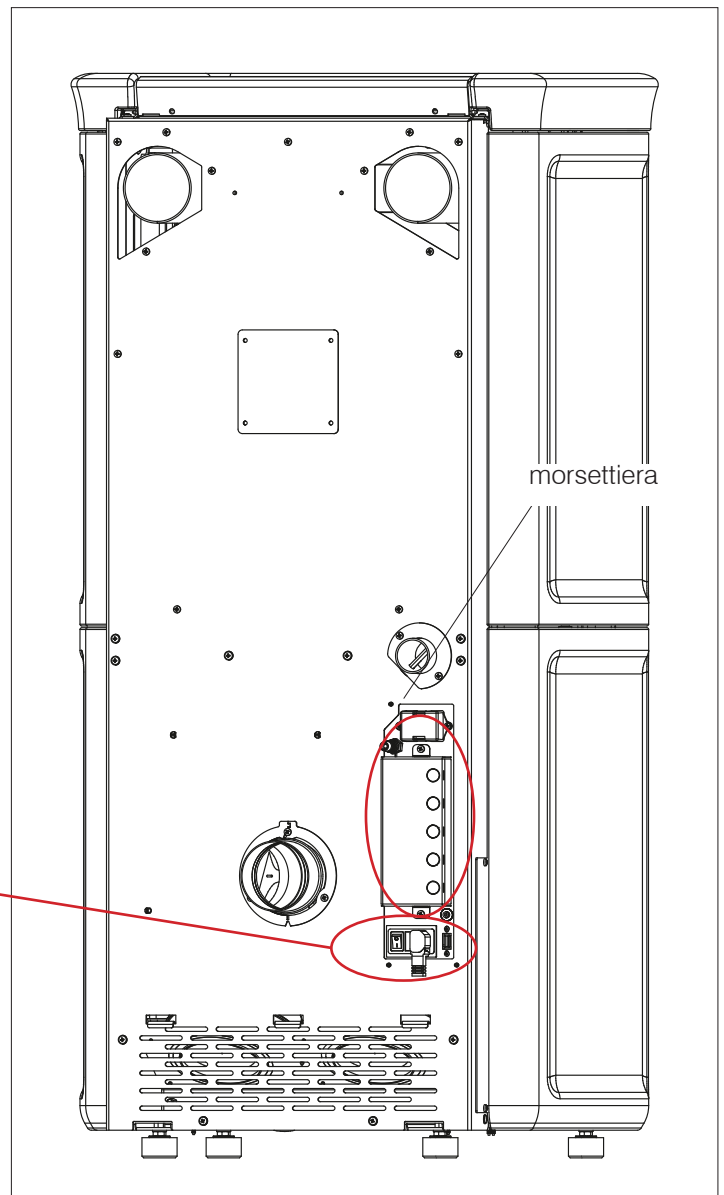
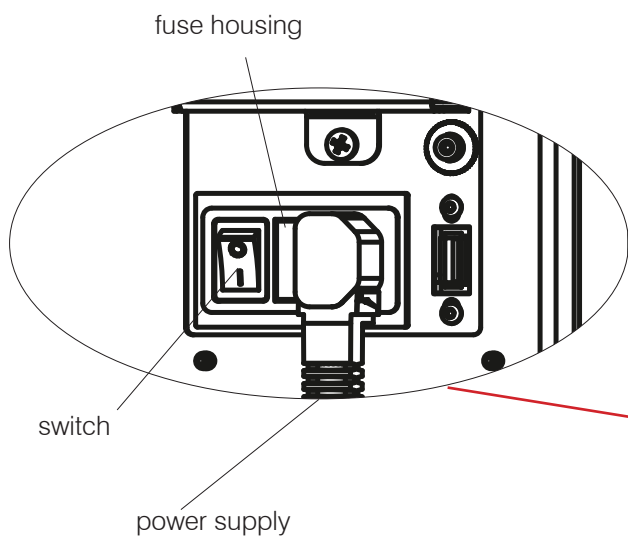

Description	Reference in Figures below	Quantity
Bottom front panel	(1)	n°1
Top front panel	(2)	n°1
Top right ceramic side	(3)	n°1
Lower right ceramic side	(4)	n°1
Lower left ceramic side	(5)	n°1
Top left ceramic side	(6)	n°1
Ceramic top	(7)	n°1

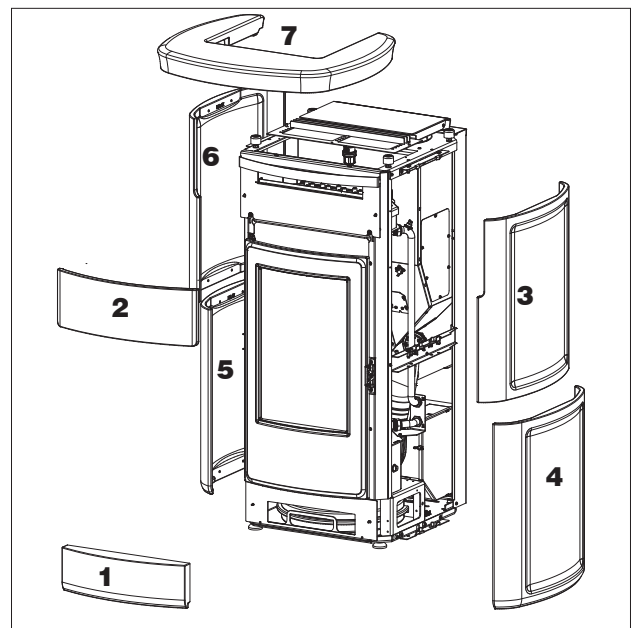
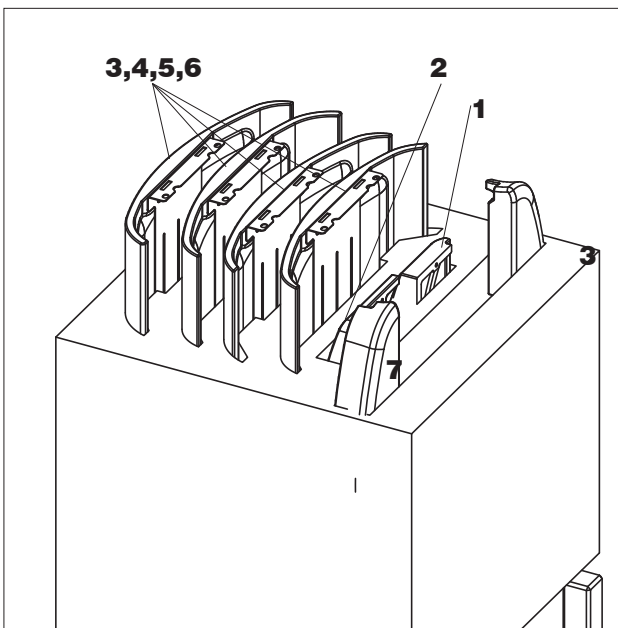

The position of each ceramic side is indicated on the interior part of each piece (example INF.DX means bottom right.)

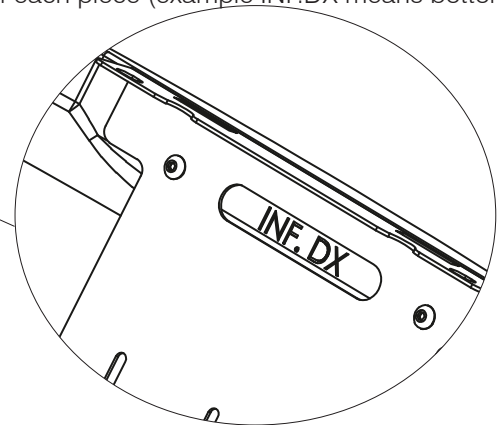
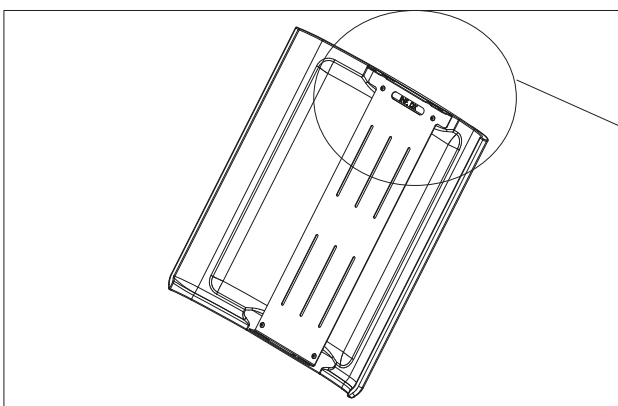

The metal grille of the top is in the package of the stove structure together with the M4 screws, fixing washers and the two rubber buffers to be applied on top of the grille

* Small parts to be used for Kira :

- M4 screws with washers for fitting the ceramic front parts
- M5 screws and washers for fitting the ceramic sides
- cable glands for the terminal board on the rear

THE DRAWINGS ARE FOR GUIDANCE ONLY, USEFUL FOR THE INSTALLATION, BUT THEY MAY NOT REFER TO THE SPECIFIC MODEL.

Fitting of the bottom front panel (1)

THE DRAWINGS ARE FOR GUIDANCE ONLY, USEFUL FOR THE INSTALLATION, BUT THEY MAY NOT REFER TO THE SPECIFIC MODEL.

1. Open the combustion chamber door with the protective lever (removable handle P) and undo two screws to remove the bottom metal front panel

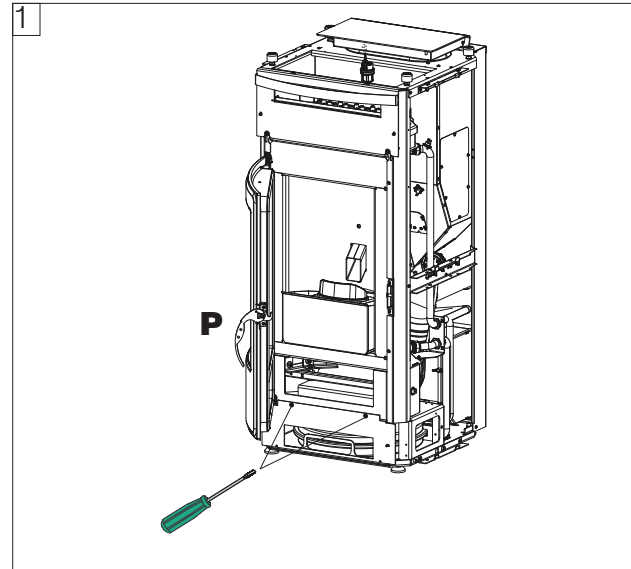

2. Fit the ceramic part on the bottom metal front panel using the M4 screws with washers

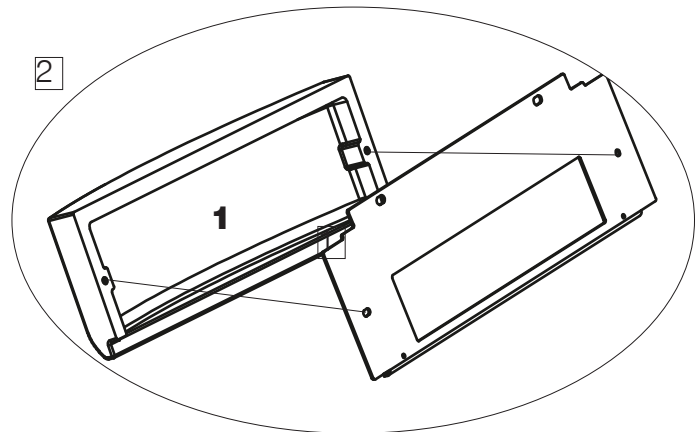

 Do not force the screw into the pin, it may break

3. Screw the bottom metal front panel - **1** (with the bottom ceramic front panel already fitted) to the stove. You can adjust the position of the front panel horizontally to align it to the door, by moving the screws in the slots

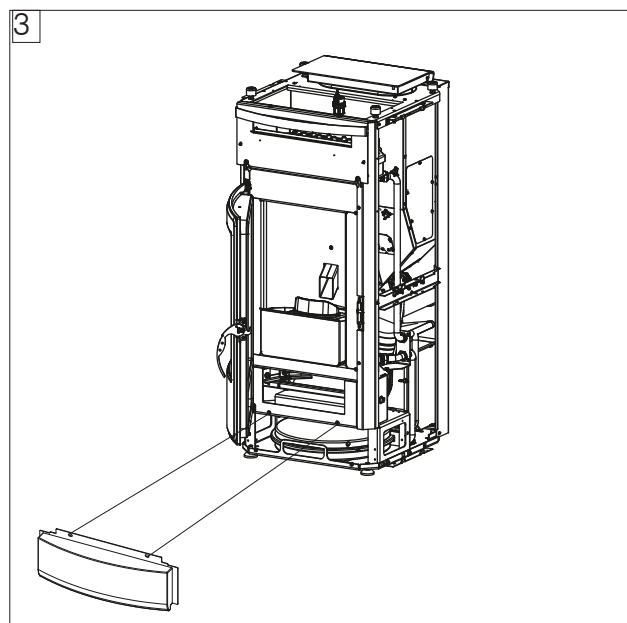
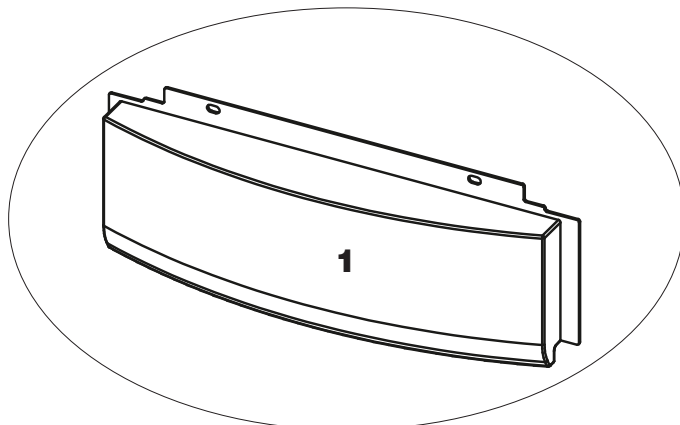

Fitting of the top front panel (2)

1. Undo the two upper screws.

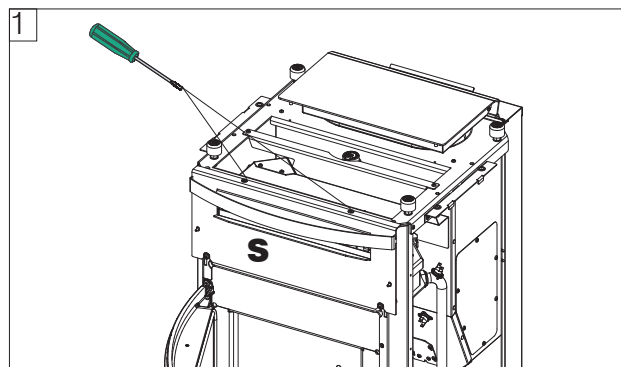

2. Remove the metal support (S).

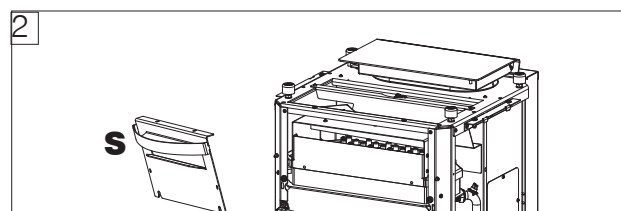

3. Place the top ceramic front panel (2) on the metal support (S).

Fit the front panel (2) with the M4 screws provided with washers

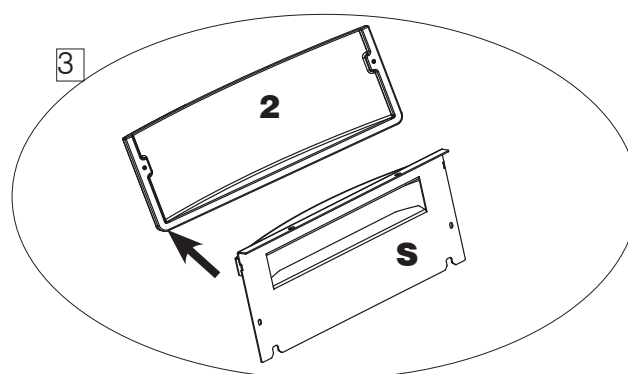

4. Replace the support with the ceramic part and screw it back to the structure by using the two screws removed in point 1

Close the combustion chamber door and check the alignments.

To make alignment adjustments between ceramic/stone and the door, you can use the top screws. Left/right adjustments can be made.

Fitting the ceramic sides (3,4,5,6)

The sides are hooked and screwed on top
Start from the bottom ceramic part of one of the two sides.

**THE DRAWINGS ARE FOR GUIDANCE ONLY,
USEFUL FOR THE INSTALLATION, BUT
THEY MAY NOT REFER TO THE SPECIFIC
MODEL.**

1. Place the rubber buffers and hook the bottom side ceramic part to the structure.

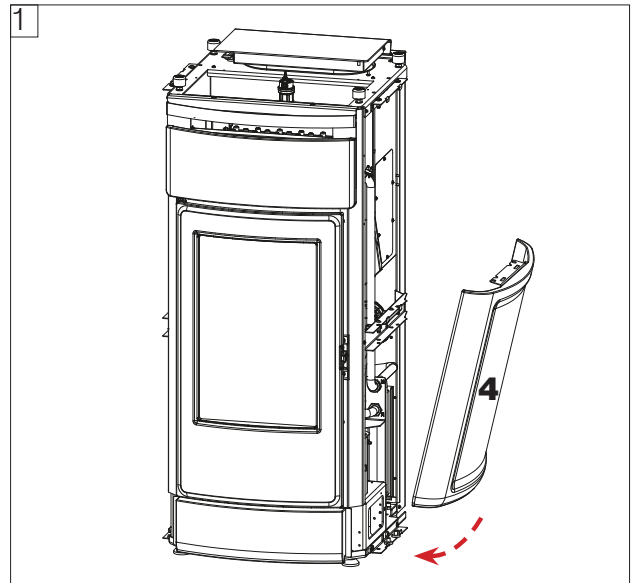
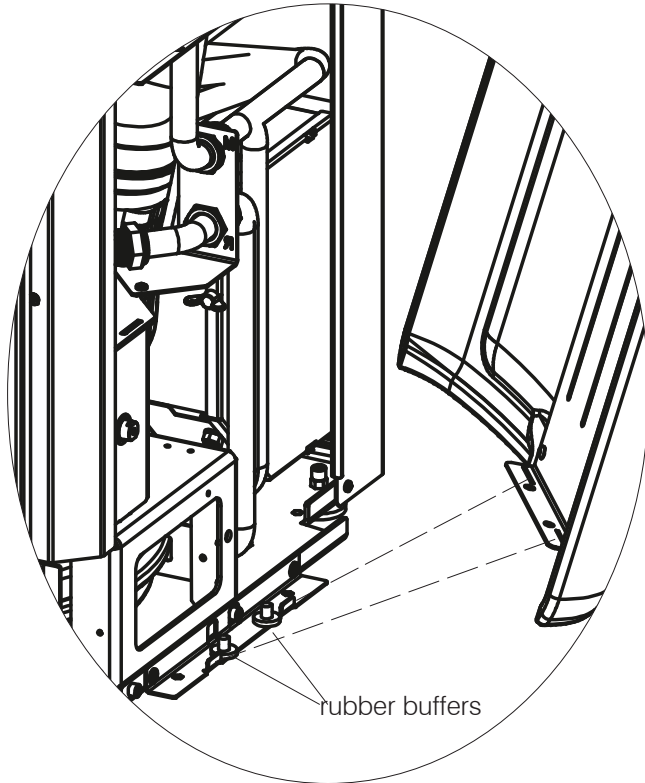

There are some other screws on the brackets that you can use for any adjustment

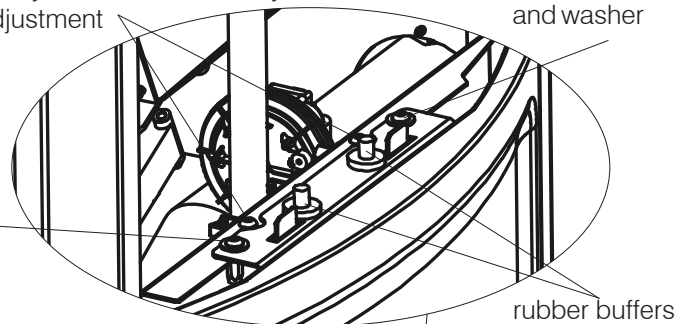

2. Screw on the sides from above with the M5 screws and the washers provided

To make alignment adjustments between ceramic/stone and the door, you can move the top or bottom screws in their slots.

The top screws allow the alignment with the top.
The bottom screws allow the alignment with the front panel and with the bottom side panel. If the ceramic or stone side is not aligned, remove it, adjust the screws and put it back.

i Take care that the side ceramic tile does not knock against the metal side when opening the door. If necessary adjust the setting to avoid breakage

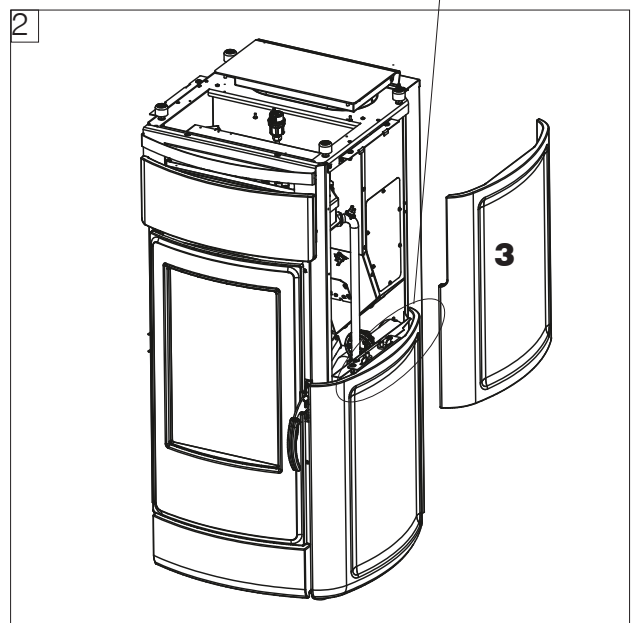

Fitting the ceramic top (7)

The top part of the lining consists of a grille (G) for the hot air output and the stone or ceramic top (4).

1. Fit the two rubber buffers provided on the top part of the grille. They can also be fitted after the grille has been matched with the top

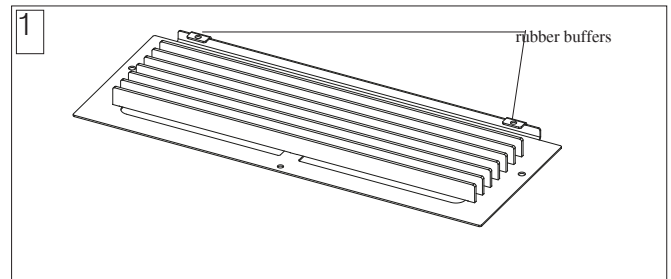

2. Place the grille under the ceramic or stone part and fit it with the M4 screws provided

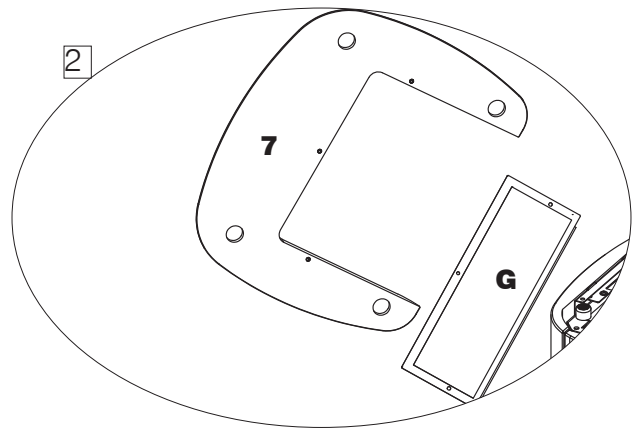

3. Open the lid of the pellet tank, place the grille and ceramic top (after screwing them together) onto the stove

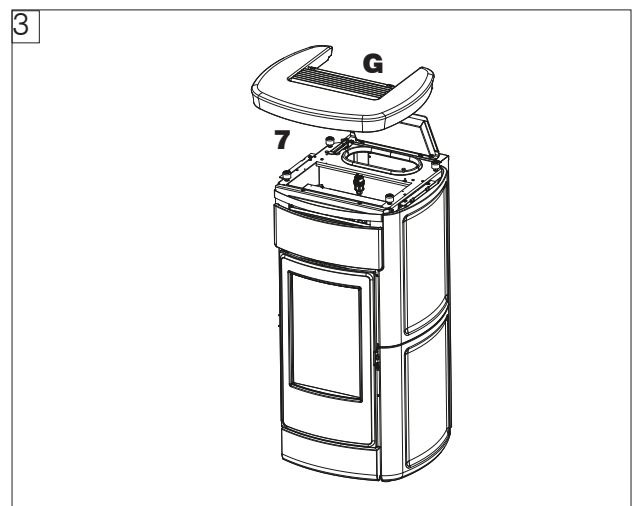

Adjustments can be made by adjusting the feet supporting the top, or the screws under the sides, as shown in the fitting of the sides (with top and side removed)

Description	Reference in the Figure below	Quantity
Front panel above the door (ceramic or stone)	(1)	1
Top front panel (ceramic or stone)	(2)	1
Left or right interchangeable sides (ceramic or stone)	(3)	2
Top (ceramic or stone)	(4)	1

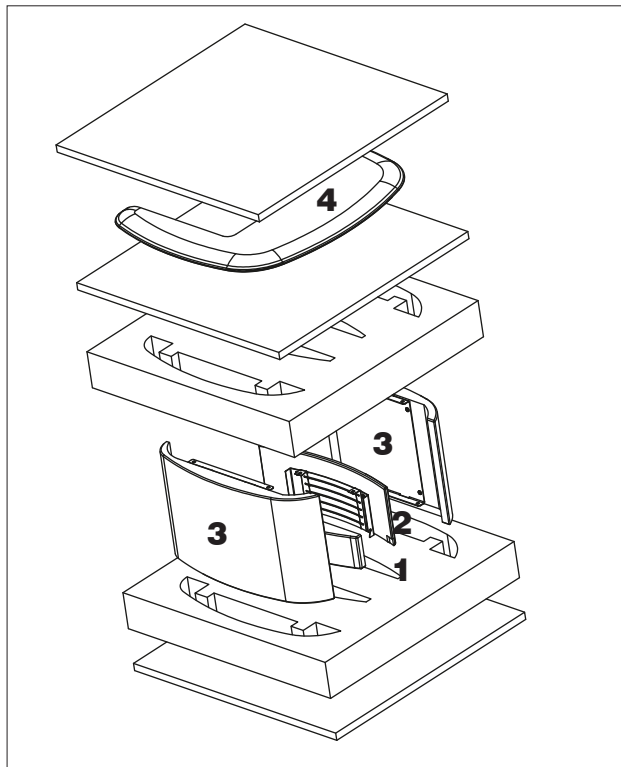

The metal grille of the top is in the stove structure package together with the M4 screws (and M6 for the stone top), the fitting washers and the two rubber buffers

* Small parts to be used for Vyda :

- M4 screws with washers for fixing the ceramic parts
- M6 screws for fixing the stone parts
- cable glands for the terminal board on the rear

Fitting of the stone or ceramic front panel above the door (1)

THE DRAWINGS ARE FOR GUIDANCE ONLY, USEFUL FOR THE INSTALLATION, BUT THEY MAY NOT REFER TO THE SPECIFIC MODEL.

1. Open the combustion chamber door with the protective lever (removable handle P) and undo two screws to remove "aesthetic cover".

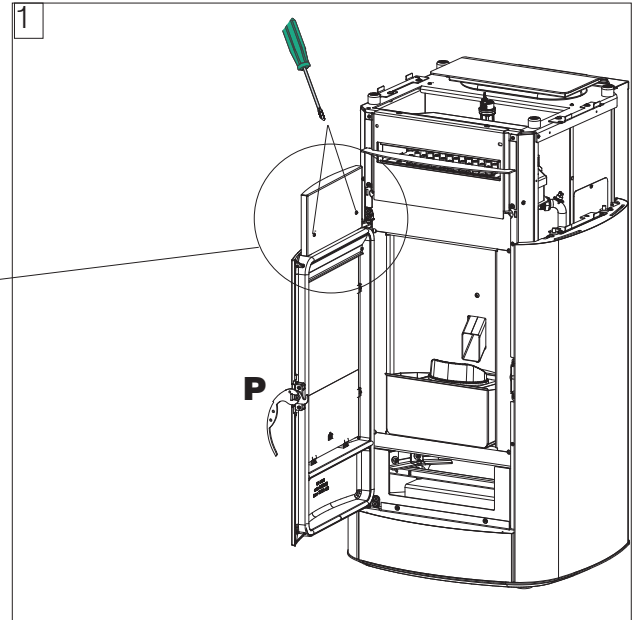
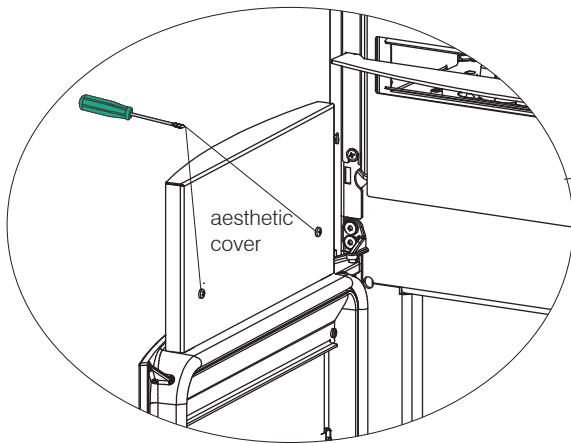

2. Unscrew the two upper screws, insert the ceramic or stone front panel (1) in the metal support above the door.

It is snapped into position on the side parts and screwed on the top part.

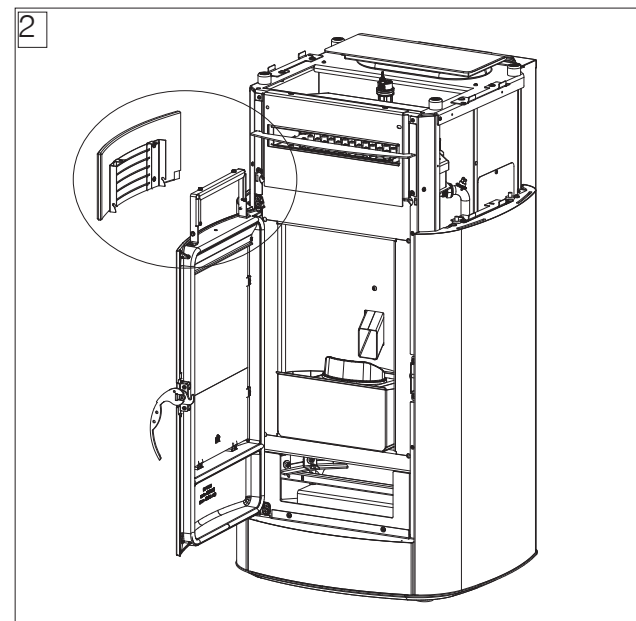
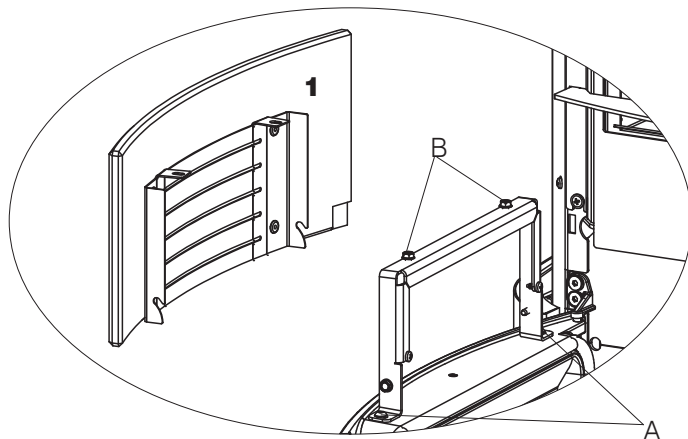

To make alignment adjustments between ceramic/stone and the door, you can use the screws A and B
Screw A can be used to adjust "backwards/forwards"
Screw B can be used to adjust the inclination

3. Refit the "aesthetic cover"

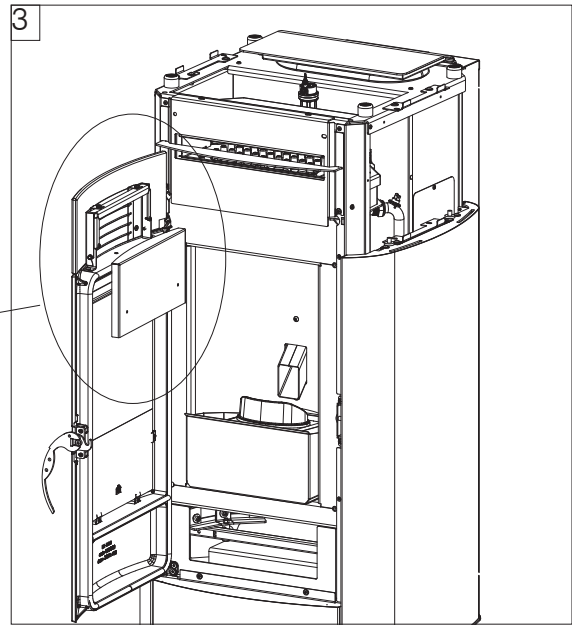
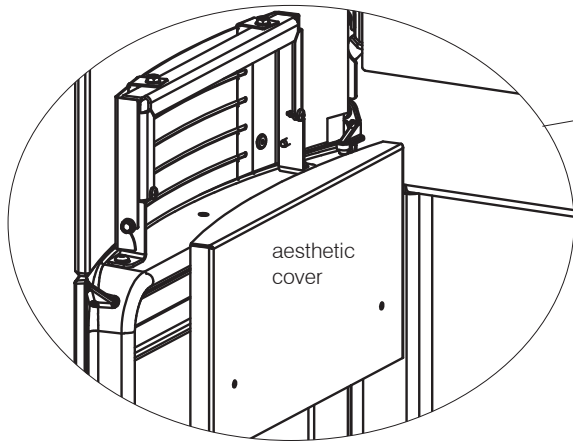

4. Screw it back with the two screws removed in point 1

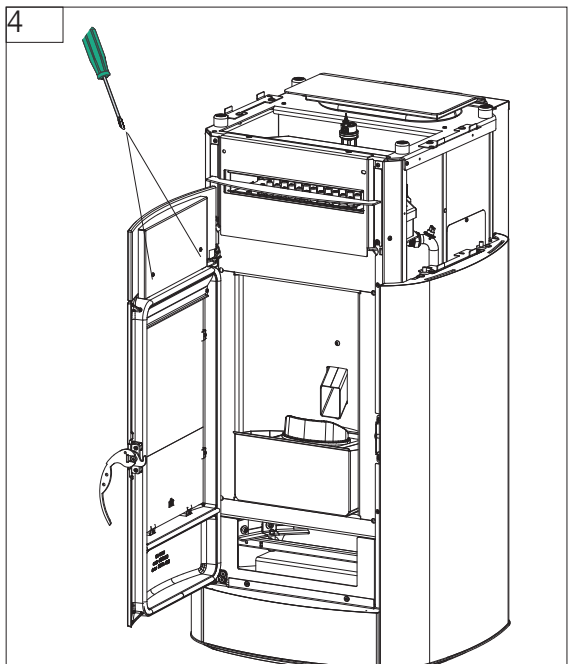

Fitting of the stone or ceramic top front panel (2)

1. undo the two upper screws

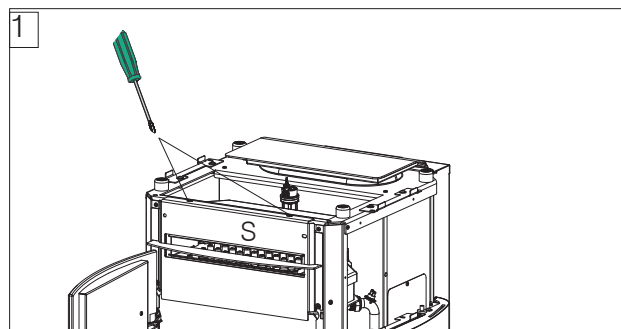

2. remove the metal support (S)

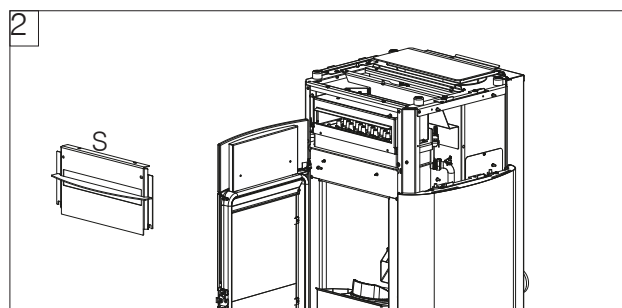

3. Place the top ceramic or stone front panel (2) on the metal support (S).

Fit the front panel (2) with the screws provided:

M4 with washers for the ceramic front panel;

M6 for the stone front panel.

Adjustments can be made by using the screws behind the front panel (S).

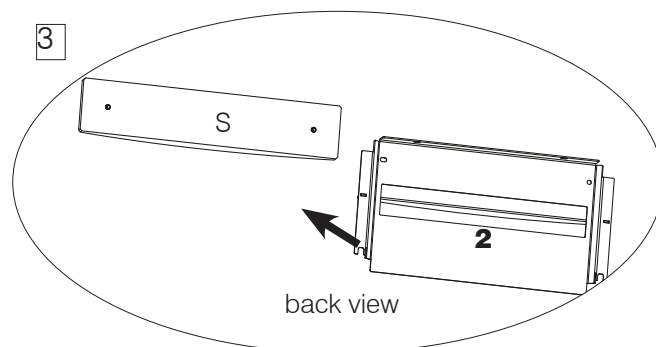

Do not force the screw into the pin, it may break

4. Replace the support with the ceramic part and screw it back to the structure by using the two screws removed in point 1.

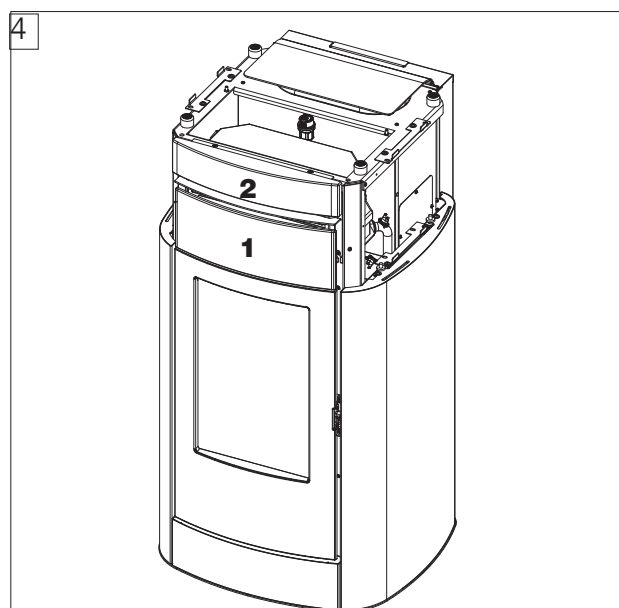

Close the combustion chamber door and check the alignments.

To make alignment adjustments between ceramic/stone and the door, you can use the top screws.

Left/right adjustments can be made.

Fitting of the stone or ceramic sides (3)

The sides (3) are only hooked on.

1. Place the rubber buffers and hook the sides to the structure

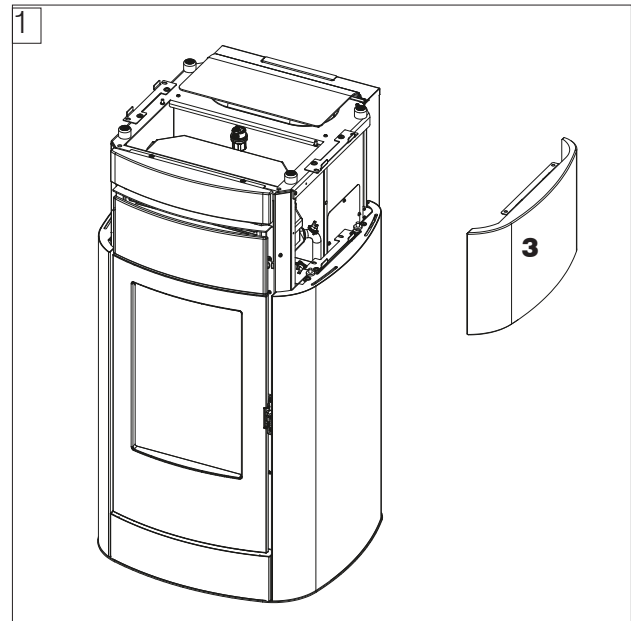
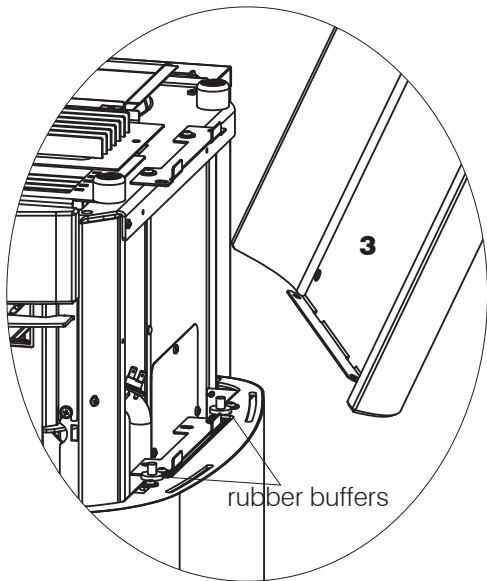

Note: see the diagram for correct installation of the ceramic tile

To make alignment adjustments between ceramic/stone and the door, you can move the top or bottom screws of the bracket fixed to the structure.

The top screws in their slots allow the alignment with the top.

The bottom screws in their slots allow the alignment with the front panel and with the bottom side one.

If the ceramic or stone side is not aligned, remove it, adjust the screws and put it back.

Fitting of the stone or ceramic top (4)

The top part of the lining consists of a grille (G) for the hot air output and the stone or ceramic top (4).

1. Fit the two rubber buffers provided on the top part of the grille. They can also be fitted after the grille has been matched with the top.

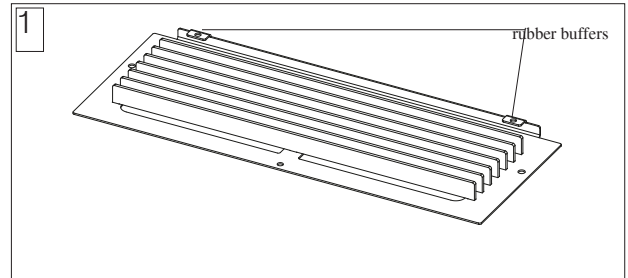

2. Place the grille under the ceramic or stone part and screw it (M6 screws for stone and M4 screws for ceramic).

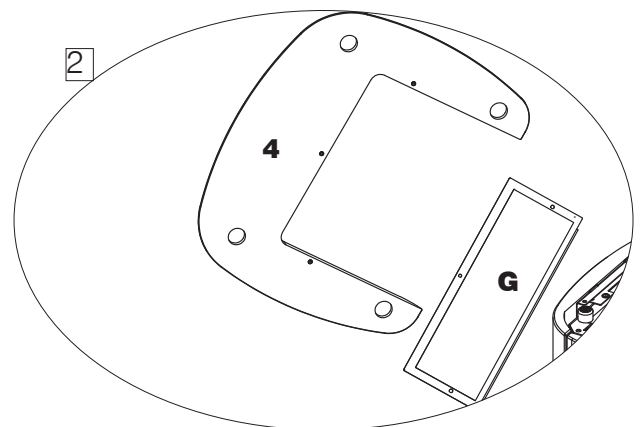

3. Open the lid of the pellet tank, place the grille and ceramic top (after screwing them together) onto the stove.



Adjustments can be made by adjusting the feet supporting the top, or the screws under the sides, as shown in the fitting of the sides (with top and side removed).

FIRST IGNITION (COMMISSIONING) PHASES

- Make sure you have read and understood this manual.
- Remove all flammable materials from the appliance (manuals, labels, etc.). In particular remove any labels from the glass.
- Make sure that the technician performs the first ignition and the first loading of the pellet tank. Refer to the "Various Menus" chapter, paragraph "pellet loading".



On first ignition, there may be a slight smell of paint, which will disappear in a short time.

FUEL

Use UNI EN ISO 17225-2 category A1 wood pellets or similar regulatory products with the following characteristics.

diameter 6 mm

length 3-4 cm

humidity <10 %

For reasons of safety and environmental compatibility, DO NOT burn plastic, painted wood, coal, bark or other such materials in the stove.

Do not use the stove as an incinerator.

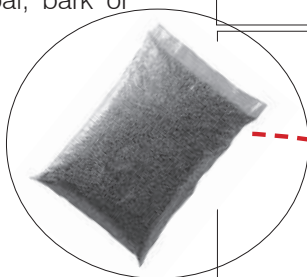

Caution
Using fuels other than those specified can damage the appliance

LOADING THE PELLETS INTO THE TANK.

To access the tank, open the lid.



When the stove is hot, DO NOT MAKE CONTACT between the pellet bag and the top grille.

Use the provided gloves when loading the stove while it is operating and hence hot to the touch.

Make sure not to touch the smoke discharge pipe if hot.

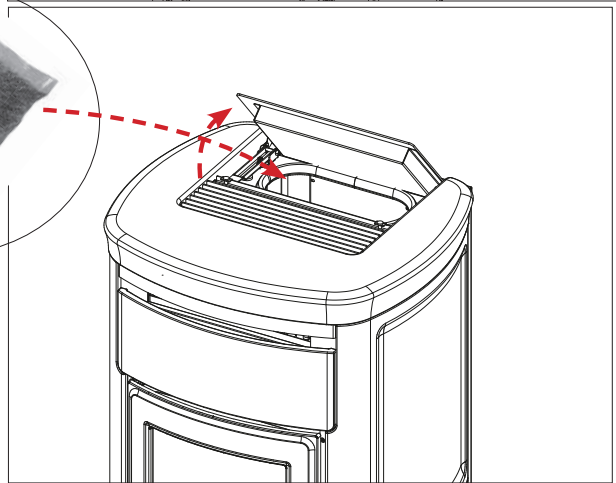
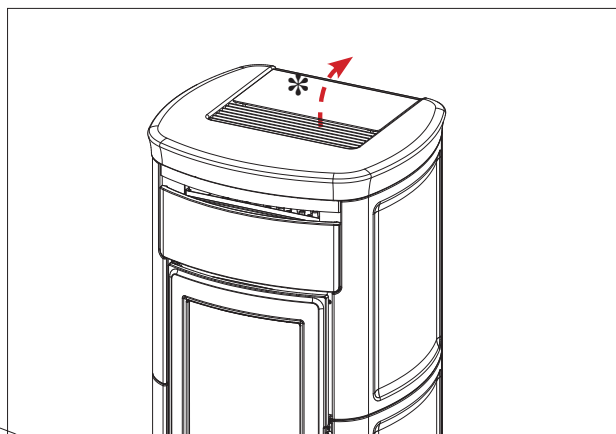

To close the lid of Kira , unhook the hook as shown in the figure below.

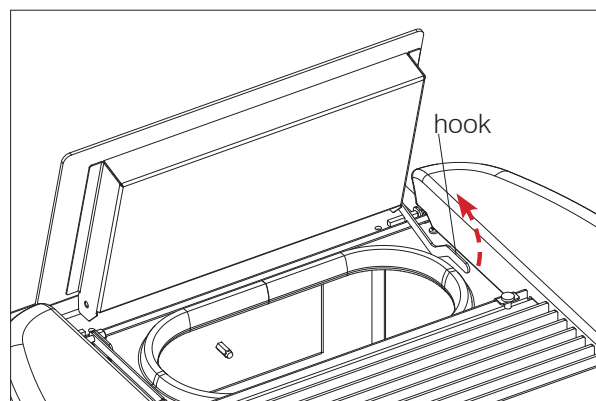

OPERATION

Mode	Size settings
MANUAL	<ul style="list-style-type: none"> power level ventilation level (the three fans can be adjusted separately) *
AUTOMATIC	<ul style="list-style-type: none"> desired room temperature ventilation level *
CRONO	<ul style="list-style-type: none"> desired room temperature, selected per day of the week ventilation level*

* when lowering the ventilation the stove also automatically modulates its power to maintain maximum efficiency.

The stove also has the following supplementary functions.

Function	In which mode it can be activated	What it does
STAND BY	automatic crono	when the desired temperature is reached, the stove shuts off and turns on again when the temperature drops
RELAX	manual automatic crono	enables natural convection mode (fan off), thus reducing the power
NIGHT	manual automatic	allows you to set the stove to go out after a given number of hours

SIMPLIFIED IGNITION BUTTON ON THE REAR OF THE STOVE

The user interface is the remote control but, if this is not available, you can control the stove with the button on the back (see figure)

1. WITH THE STOVE OFF
press the button for 2" to turn the stove on.
2. WITH THE STOVE ON
press the button for 2" to turn the stove off.
3. WITH THE STOVE ON IN MANUAL MODE
by pressing the button once and releasing it immediately, you can increase the operating power.

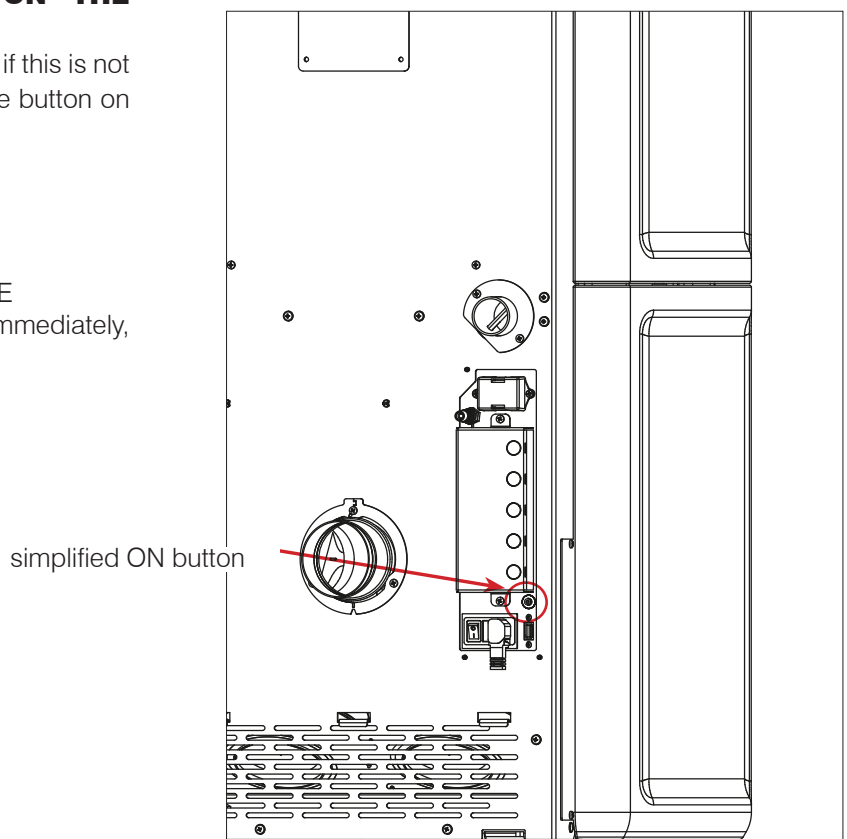

INTERFACE

The interface is the display on the remote control. The views display the functions and are described in the following sections

REMOTE CONTROL

ON/OFF button

manual on/off button and for switching the remote from energy saving mode to active heating

Touch buttons:

+/- to increase/decrease the set values or scroll between the Menu options

M: to access the Menu or activate the Relax mode

OK: to confirm an operation (2 seconds) or to access an item on the Menu or to move from Automatic to Manual Mode and vice versa.

NOTES

- The remote control exchanges information with the logic board (including room temperature sensing in automatic mode) every 2' and when it is activated by pressing the ON/OFF button.
- In normal use, the remote control's batteries should last a year. This duration is for illustrative purposes only. Edilkamin and the reseller will not consider claims for battery life under any circumstances. If the battery charge is low, a warning displays at the top left (see the paragraph on "If problems arise").
- Characteristics: RF transceiver module, frequency 2.4 GHz - Powered by two AAA 1.5 V batteries rated at least 1200 mAh. Risk of explosion if the batteries are replaced with other batteries of an incorrect type.

POWER SAVING ON THE REMOTE CONTROL

If the remote control is not used for 20 min., the display turns off. This only refers to the remote control, not the product itself.

To turn the display back on, press the ON/OFF button.

DO NOT PRESS THE ON/OFF BUTTON REPEATEDLY; otherwise in manual mode, you may inadvertently switch the product on and off.

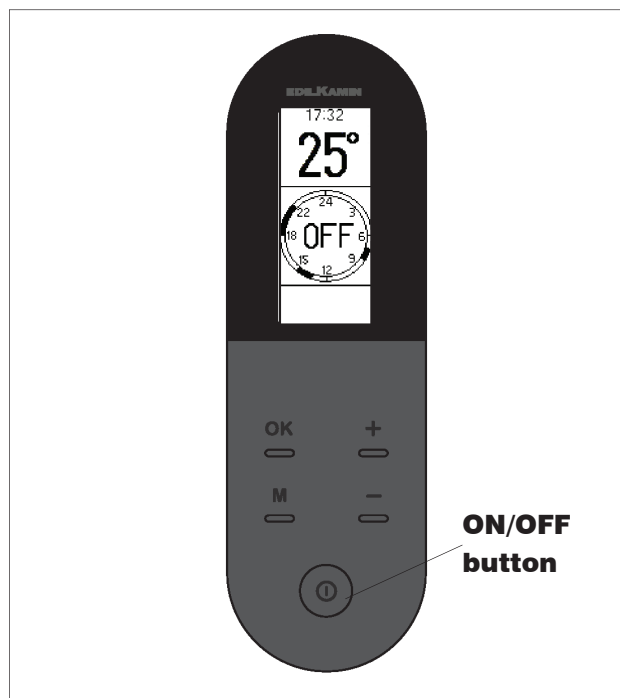

POWERING THE REMOTE CONTROL

- Open the bottom of the remote control and insert the 2 batteries in the way indicated.
- Supply mains power to the product.
- **WHEN YOU HEAR THE AUDIBLE SIGNAL, PRESS THE ON/OFF BUTTON.** Otherwise the remote control will not work.

If at the first power on the language is not set, the language selection screen will display on the side. Choose the language with the +/- buttons and confirm with OK.



THE COMMAND SIGNAL IS CONFIRMED BY AN AUDIBLE SIGNAL. IF THE AUDIBLE SIGNAL DOES NOT SOUND, THIS MEANS THE BUTTON WAS PRESSED TOO BRIEFLY.

The display reads the **POSSIBLE STATES** described below:

- OFF STATE

The product is shutting down or is off in response to a manual switching off by using the ON/OFF button of the remote control or due to an external contact (crono, phone dialler)

The display shows the current time, room temperature and the status in relation to which the product is OFF.

The product is OFF:

due to manual operation of the user (fig. 1)

due to power failure (fig. 2)

due to shut off by Crono mode (fig. 3)

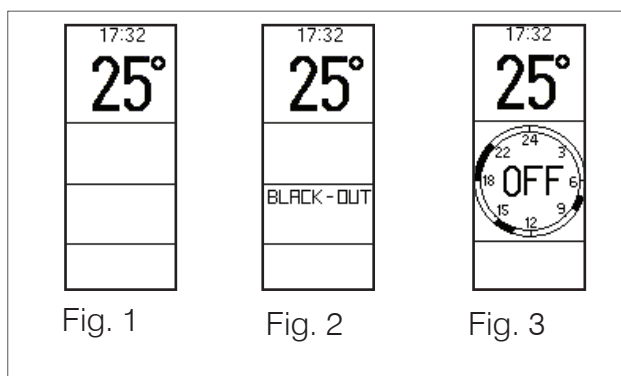

From the OFF screen, press the ON/OFF button for 3 seconds to switch to the ON screen.
Pressing the +/- keys has no effect.
Pressing the M key displays the menu.

- ON STATE

The product is ON.

The display shows (figure 4)

1. the current time
2. the current room temperature
3. the room temperature setting or manual mode
4. the power level (represented by the flames)
5. the fan level (represented by the filling in of the blades)

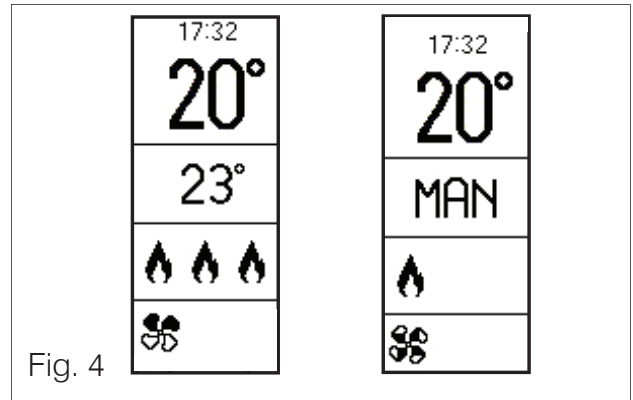

Fig. 4

If timer programming is active, 3 and 4 are replaced by the day's timer programming with the current setpoint at the centre (figure 5) and the temperature displayed at the top right.

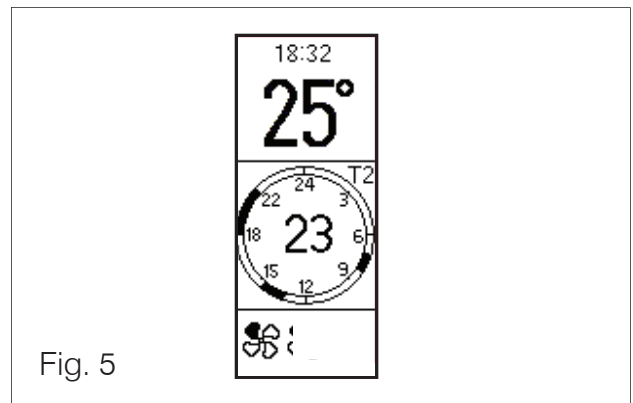

Fig. 5

- ALARM STATE

In case of shutdown due to alarm, 4 is replaced by a message indicating the type of shutdown (figure 6)

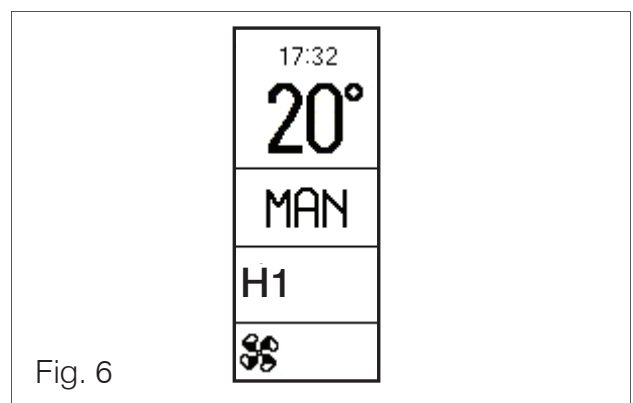

Fig. 6

- STAND BY STATE

Situation in which there is no demand for heating.

If the Stand By function is active, the display shows the same information as in the ON state without flame (on the top left you will see "STB").



While in stand-by mode, and ON, the product turns on only if there is a heat request

USER CONTROLS (REMOTE CONTROL)

- ON/OFF

- Switch-on/switch-off

- Manual mode setting

- Setting the power
- Setting the fan

- Automatic mode setting

- Setting the required temperature
- Setting the fan

- RELAX function

- From the **Menu page:**

- **Pellet Load** (shown only when the product is OFF)
- **Stand By**
- **Crono**
- **Night** (shown only when the product is ON)
- **Date / time**
- **Display**
- **Language**
- **Beep**
- **Info** (technician only)
- **Technical menu** (technician only)



Switching on and off will take a few minutes, during which the flame must appear or go off. Just wait without taking any action.

During ignition, the display shows the text "ON".

During switch-off, the display shows the text "OFF".



We describe the procedures below.

ON/OFF

hold the ON/OFF button down to turn the product ON. When ON, the product has a flame (ignition phase, etc.) when there is a heating demand.

Switch-on/switch-off

The ON/OFF button switches the product on (starts the ignition phase) or off (starts the switch off phase) manually **in Manual mode only.**

In Automatic mode, the product responds to the heating demand.

Setting Manual/Automatic

Press the OK button for 2 seconds to switch from manual to automatic or vice versa.

In Manual mode, the display reads "Man".

In Automatic mode, the temperature displays.

In automatic:

Setting the Room Temperature (read by the remote control, which should be in the room where the product is installed)

Set the temperature setpoint (Set) with the "+" and "-" buttons.

In manual:

Setting the Power

Set the power level (displayed by the flame symbol) with the "+" and "-" buttons.

The power level displays next to the flame symbol.

Fans/ducting

The stove is equipped with three fans, which can be regulated for speed separately.

They are indicated as fan 1, 2 and 3 and their situation is shown at the bottom of the remote control display.

Fan 1 always blows air frontally

Fans 2 and 3 can blow air frontally or towards the ducting.

The direction of fans 2 and 3 can be regulated using the levers on the stove: each lever regulates the direction of the fan on the same side.

Examples in the Figures below

Setting the Fan

Follow the instructions below to manually regulate the power levels of fans 1, 2 and 3.

Press "OK" once.

The fan setting is shown on the display, next to the blade symbol representing the fan.

Set the fan level using the "+" and "-" buttons.

The "blades" fill in to indicate the current setting.

Confirm by pressing the "OK" button for 2 seconds.

First adjust fan 1 and then fan 2.

Fan setting 1 can also follow the power.

To activate this mode, press the + button to above the maximum fan setting. Letter "A" will appear next to the "blades" symbol.

Fan settings 2 and 3 can be increased or decreased or turned off (fan setting 1) using the +/- buttons as described above or can follow the power demand (decrease when the power is decreased or increase vice versa).

To activate this mode, press the + button to above the maximum setting. Letter "A" will appear next to the "blades" symbol.

To ensure that the speed of fans 2 and 3 varies according to the room temperature demand, contact the Edilkamin technician, who will be able to fit dedicated sensors.

THE NUMBER NEXT TO THE "BLADE" OR "FLAME" ONLY DISPLAYS WHILE THE SETTING IS BEING MADE.

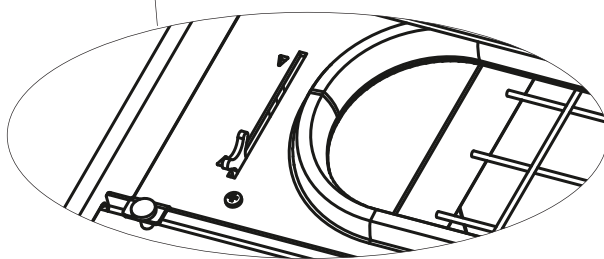
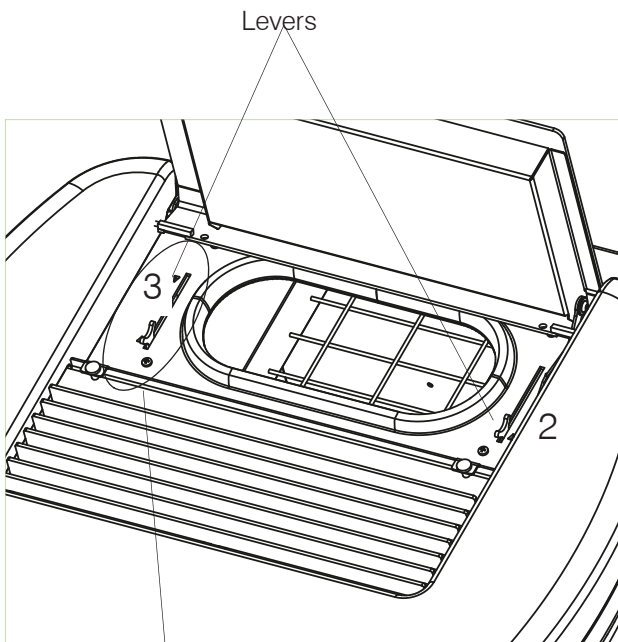

**Lever backwards =
Air blows frontally, not to the ducting**

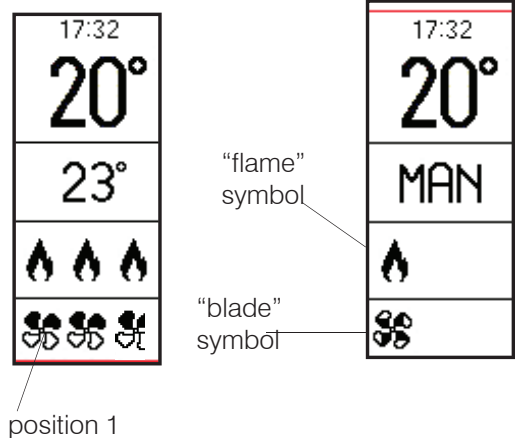

- Relax function

Natural convection function (without ventilation) with automatic power limiting.

This function is available in all modes: automatic, manual and crono.

Hold down the “M” button for two seconds to activate the Relax function.

The display reads the  symbol, as shown below.

Hold it down again to deactivate it.

The product reduces its power output and after a few minutes switches the fan off too.

Pressing OK or “+” or “-” in this mode has no effect.

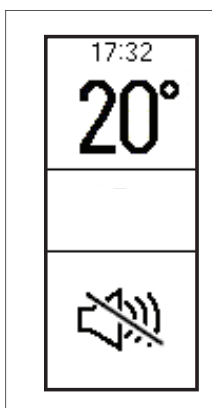

- Stand by

When the Stand by function is active, in automatic and crono modes, the product shuts off when the temperature setpoint is reached and turns on again when the room temperature drops.

When the Stand By function is not active, the product sets itself to minimum power when the temperature setpoint is reached.

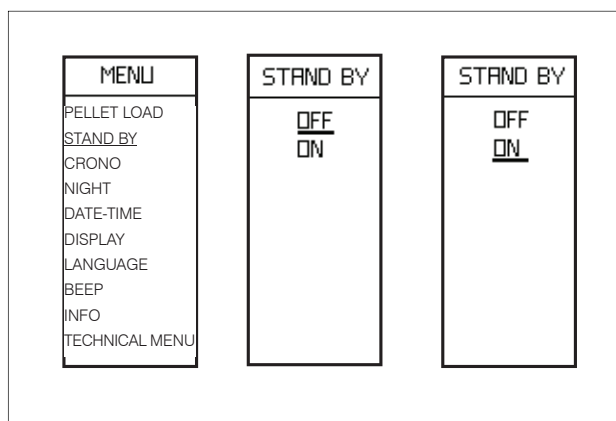

To access the function from the main menu (as indicated in the Menu section above), press the M button. Scroll using the +/- buttons and select the function by pressing the “OK” button.

Use the “+/-” buttons to select OFF or ON.

To exit without saving, press the “M” button

If you selected ON, the display shows the minutes for which the product will continue running at minimum power even when the temperature setpoint has been reached.

Use the “+/-” buttons to increase or decrease this time in minutes.

Press “OK” for two seconds to confirm and return to the previous menu level.

Press the ON/OFF button to return to the main screen.



The product is programmed by default with a delta of +/- 1 °C to optimise comfort.

The technician can change this setting during commissioning to suit the needs of the application.

The display shows the temperature rounded down. This means that 20.1°C and 20.9°C are indicated as “20°C”.

E.g., with the room temperature set to 20°C, the product will enter modulation mode/switch off when a temperature of 21° C is reached and will switch on again below 19° C.

Menu

Press the “M” button to display the menu.

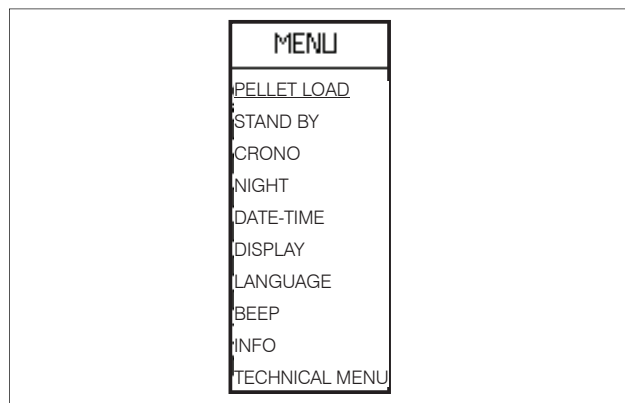

When the menu displays, the buttons have the following functions:

“+” : scroll up

“-” : scroll down

press and release “OK”: enter menu option

press and release “M”: quit menu option

Press the ON/OFF button to confirm and return to the main screen.

- Crono

When the Crono function is active, the user sets a temperature setpoint and a time zone for which that setpoint is specified.

The setting takes different steps, which can also be non consecutive:

- activate/deactivate Crono mode
- setting of three different temperature levels (T1 must always be lower than T2 and T2 than T3)
- choose if you want to apply the same Crono for 7 days a week, 5 days a week, weekend only or different day by day (figure A) and match one of the three temperatures to the time period (figure D)

You can also display the time periods and the set temperatures ("DISPLAY" selectable with the "OK" button from the Crono function).

The ON/OFF button always allows you to return to the main screen.

Activation/Deactivation of the Crono function ("ACTIVATE" on the display)

To access the Crono function from the main menu, press the M button. Scroll using the +/- buttons and select the function by pressing "OK". To select "ACTIVATE" press "OK".

Use the "+/-" buttons to select On/Off, i.e. activate/deactivate the function.

To exit without saving, press the "M" button.

Confirm by pressing the "OK" button for two seconds. When the Crono function is disabled, the product operates in automatic mode.

Setting the temperature levels ("TEMP" on the display)

To enter the setting ("TEMP" on the display) press the "OK" button.

The Crono has three adjustable setpoints: T1, T2, T3 (Figures B and C). You can switch between one level and the other with the "OK" button.

Set the temperature setpoint for each level with the "+" and "-" buttons. T1 must always be lower than T2 and T2 than T3: if you try to set a T1 temperature that is greater than T2, T1 temperature will automatically match T2.

Confirm by pressing the "OK" button for two seconds.

Setting the Crono function ("SET" on the display)

From Crono, press the "OK" button to enter the "SET" function. The first screen allows you to choose whether to apply the same Crono configuration for 7/7 days, 5/7, weekend only or day by day. (Figure A).

The second screen (top part of figure B, accessible by pressing the "OK" button from the first screen), allows you to choose the temperature level between T1, T2 and T3 previously set. Press OK to set the start and end of the time period to which you wish to apply the chosen temperature level. This is done in steps of 30'. Sequence on figures D-I.

The buttons have the following functions:

"+" : increase time. Hold the button down to scroll through the times more quickly.

"-" : decrease time. Hold the button down to scroll through the times more quickly.

"OK": confirm the time

"M" : return to the previous menu

ON/OFF: return to the main screen.

The ignition times are indicated by the fact that the dots are black. In zones with white dots, the appliance is OFF. Example in figure G (where the start time is set to 6.30 and the end time to 8.30 with T2).

Figures H/I show an example of T1 setting.

Once the time zones have been set, press "OK" for two seconds to confirm. The settings will not be saved otherwise.

To reset all programming, press the "OK" button for a long time on the screen in Figure B.

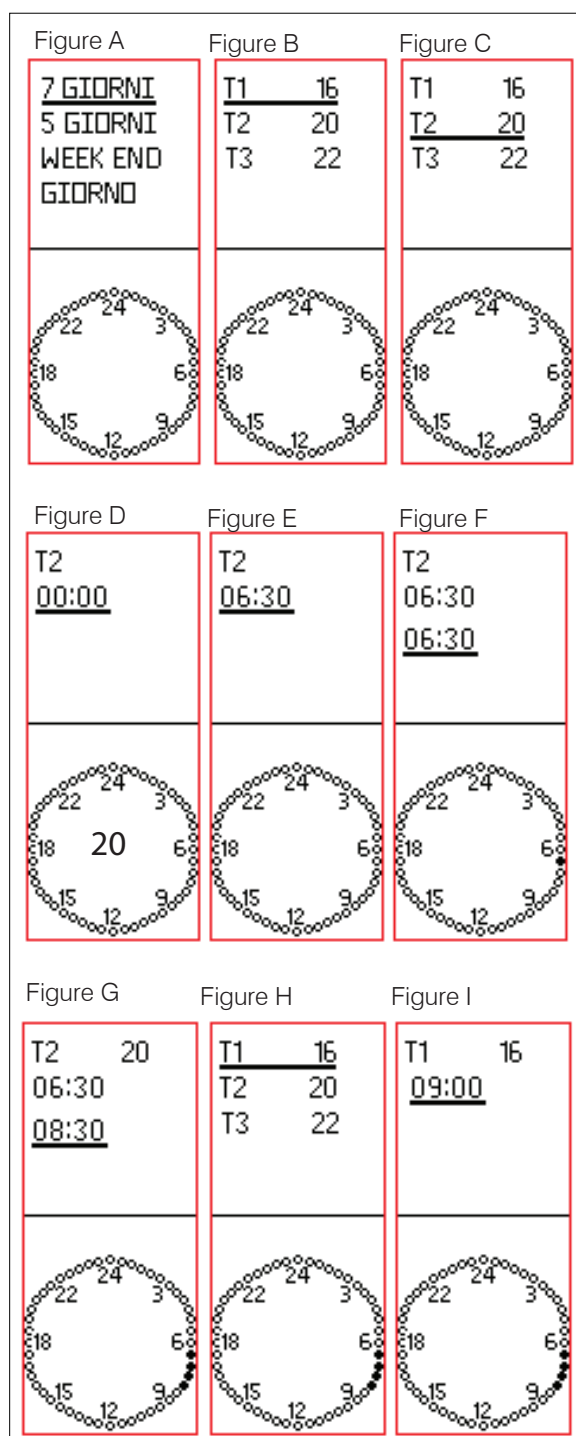

- Night

This function shuts the product down after a set number of hours from activation of the function. this is convenient if you go to bed and want the product to shut off after a few hours. The Night function is not visible when the product is OFF.

Activating the Night function

To access the function from the main menu (as indicated in the Menu section above), press the M button. Scroll using the +/- buttons and select the function by pressing OK. Use the "+/-" buttons to activate/deactivate the function. To exit without saving, press the "M" button. Confirm by pressing the "OK" button for two seconds.

Setting the hours

Press "+" to increase the duration. To exit without saving, press the "M" button. Confirm by pressing the "OK" button for two seconds. Press the ON/OFF button to return to the main screen.

With the Night function active, the display shows the moon at the top left.

To quit the function, return to the menu and set the Night function to deactivated. The procedure is the same as for activation.

Pellet Load

Allows you to load pellets after the worm screw has emptied following a no-pellets alarm. Used by the technician during commissioning. Available only in the OFF state. If you attempt to activate the function in other states, access is not granted. To access the function from the main menu (as indicated in the Menu section above), press the M button. Scroll using the +/- buttons and select the function by pressing OK. Use the "+/-" buttons to activate/deactivate the function. Press "M" to quit without saving. Confirm by pressing the "OK" button for two seconds.

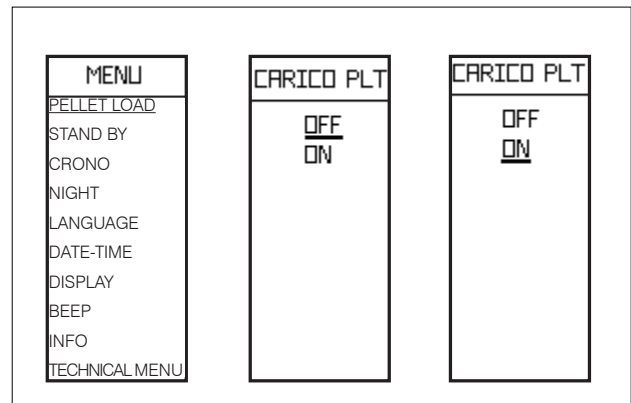

Language

Selects the language. This displays the first time the remote control is activated with the product powered on, or by selecting the option in the menu. To access the function from the main menu (as indicated in the Menu section above), press the M button. Scroll using the +/- buttons and select the function by pressing OK. Use the "+/-" buttons to select the language. To exit without saving, press the "M" button. Confirm by pressing the "OK" button for two seconds.

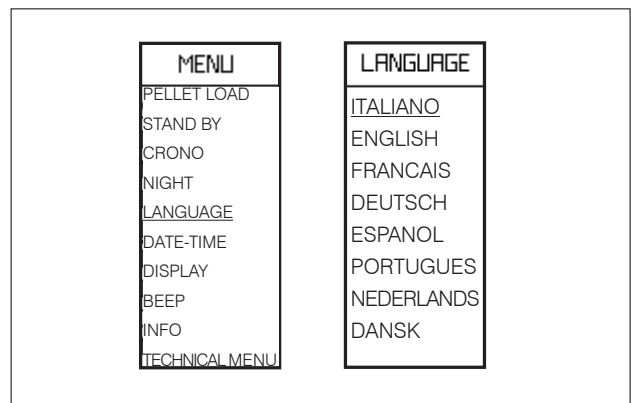
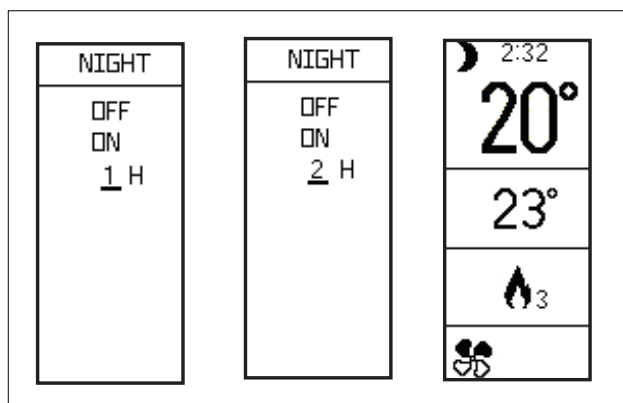
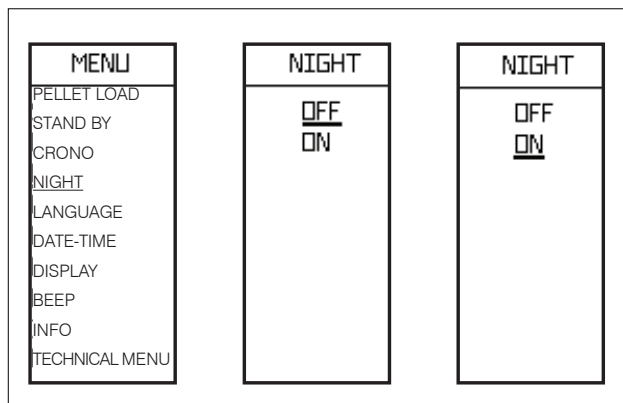

Date/Time

Sets the current date/time.

This displays the first time the remote control is activated with the stove powered on, or by selecting the option in the menu.

To access the function from the main menu (as indicated in the Menu section above), press the M button. Scroll using the +/- buttons and select the function by pressing OK.

Use the “+/-” buttons.

Press “M” to quit without saving.

Confirm by pressing the “OK” button for two seconds.

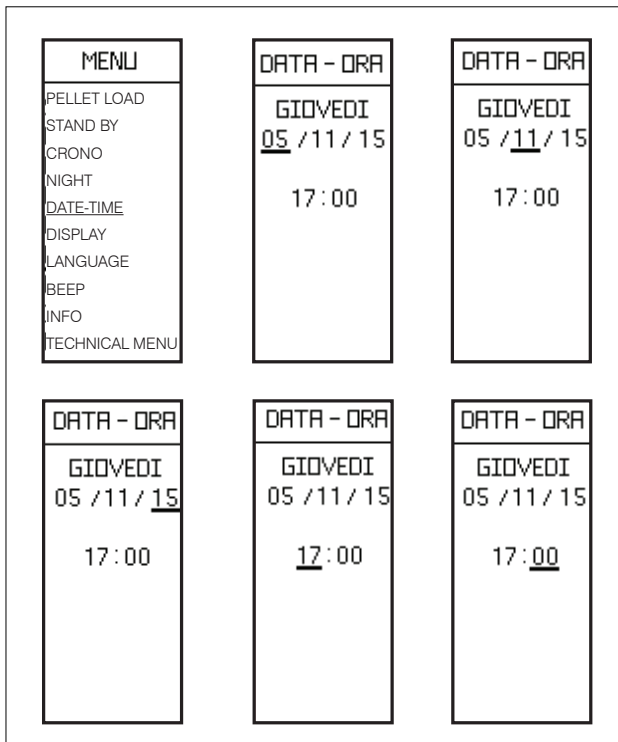

Beep

Allows you to enable/disable the beep.

To access the function from the main menu (as indicated in the Menu section above), press the M button. Scroll using the +/- buttons and select the function by pressing OK.

Use the “+/-” buttons to select On/Off.

Press “M” to quit without saving.

Confirm by pressing the “OK” button for two seconds.

Info

These readings should only be done when requested by the technician.

The technician understands the diagnostic meaning of the messages and numbers, and may ask you to read them if you experience problems.

Technical menu

Accessible only to an authorised technician with the appropriate password.

Display

Sets the display background, from White to Black.

To access the function from the main menu (as indicated in the Menu section above), press the M button. Scroll using the +/- buttons and select the function by pressing OK.

Use the “+/-” buttons to select the colour.

Press “M” to quit without saving.

Confirm by pressing the “OK” button for two seconds

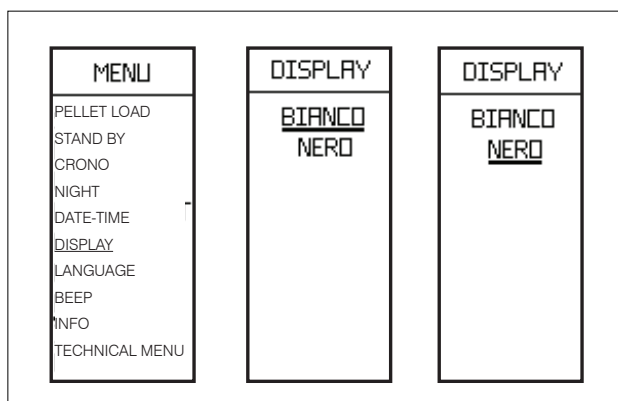

**Disconnect the product from the power supply.
Failure to service the product properly will prevent it from working properly.
Any problems due to failure in servicing the stove will void the warranty.**



Using the stove without cleaning the grate can cause the gas in the combustion chamber to ignite and detonate.

DAILY MAINTENANCE

These operations must be done with the product off, cold and preferably disconnected from the mains.

A suitable vacuum cleaner is required.

The entire procedure takes just a few minutes.

1. Open the combustion chamber door (P) using the protective lever (removable handle)
2. Empty the ash tray (B) and the grate (C) into a non-flammable container (the ashes may still contain embers and/ or hot parts, or clean using a vacuum cleaner if cold. Vacuum out the interior of the fireplace, the bed, and the compartment around the grate into which the ash falls.
3. Scrape the grate with the provided scraper and clean out any obstructed holes.
4. Clean the glass (when cold) if necessary, by using a suitable product (such as Glasskamin) available at the retailer..

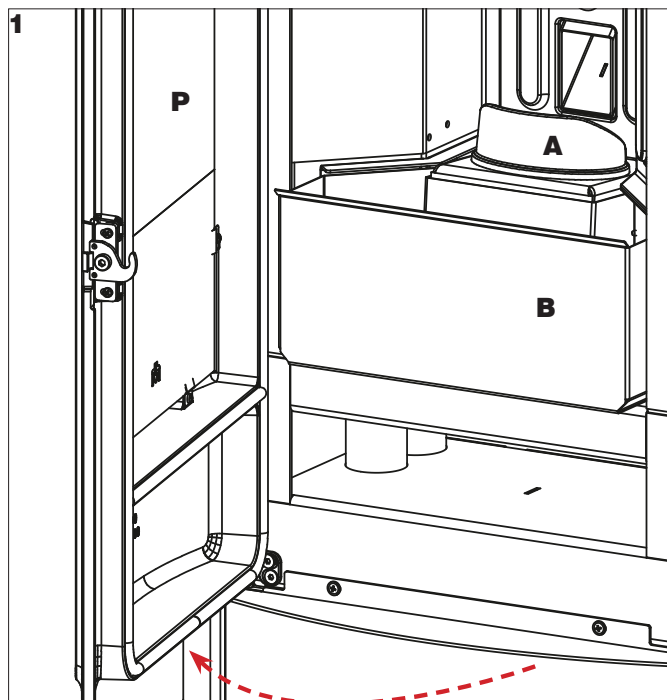

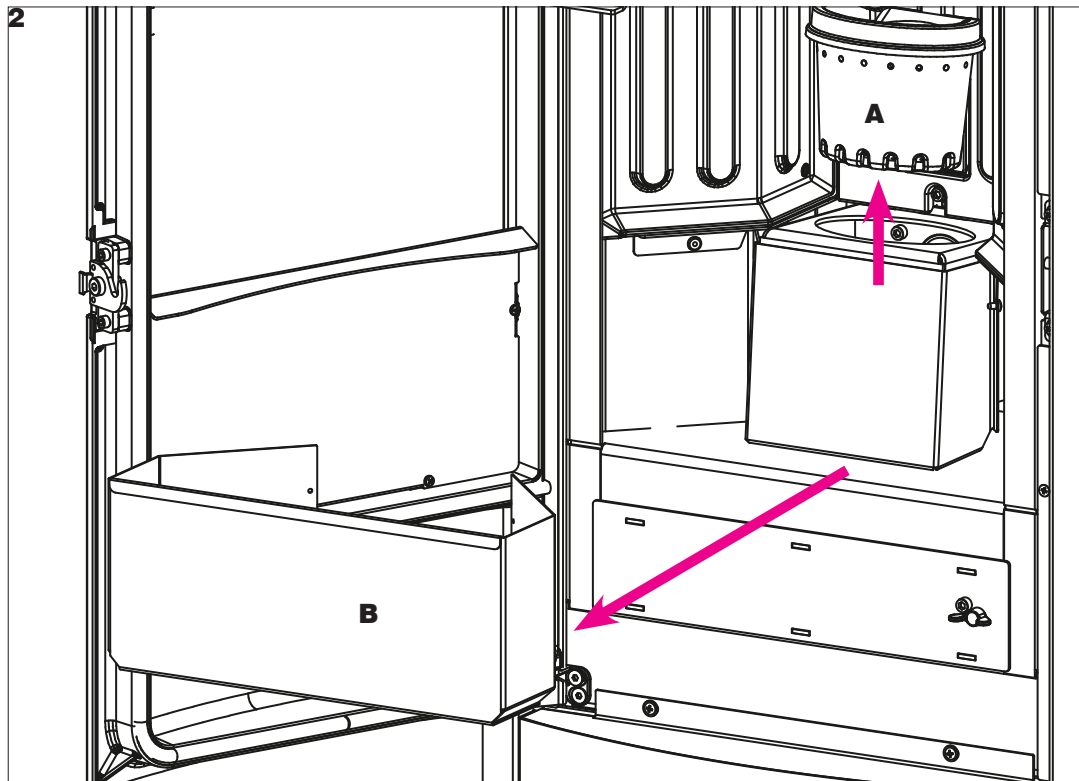

- Do not dump the cleaning residue into the pellet tank.
- Once it is refitted, make sure that the ash tray is properly placed in its housing, to avoid glass breakage when closing.
- Make sure that the grate is properly placed in its housing after maintenance operations, if not, the stove may have ignition problems.

WEEKLY MAINTENANCE

When the product is off and cold, after having routine maintenance, you should vacuum the inspection plate under the combustion chamber (*)

To do so:

- Remove the protection, by turning the wingnut (V)
- remove the deflector (D) which is only resting on it.

Put back the deflector after cleaning.

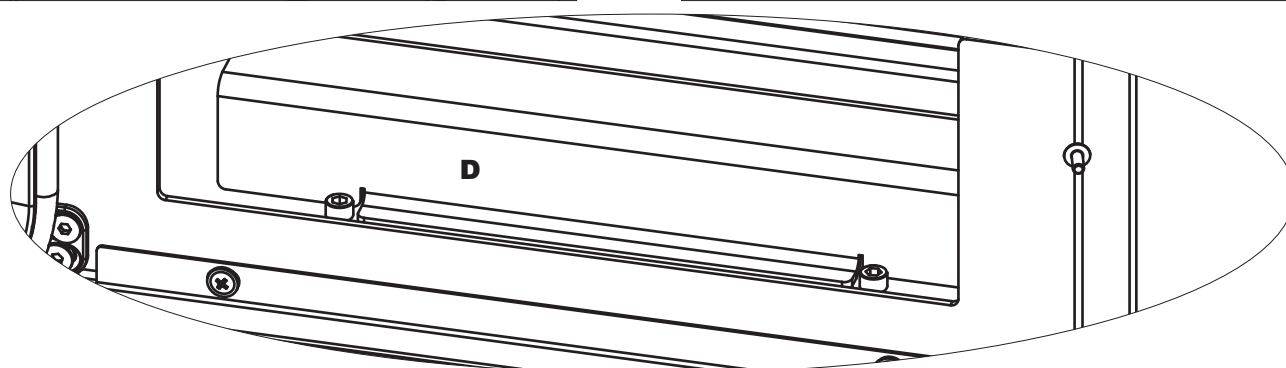
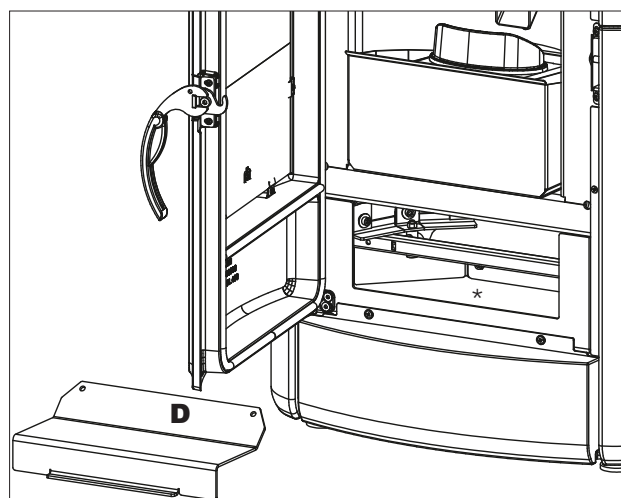
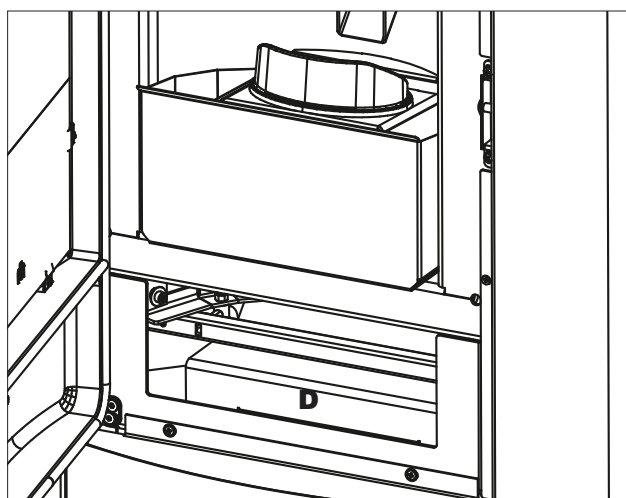
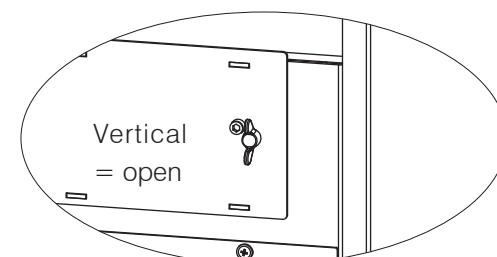
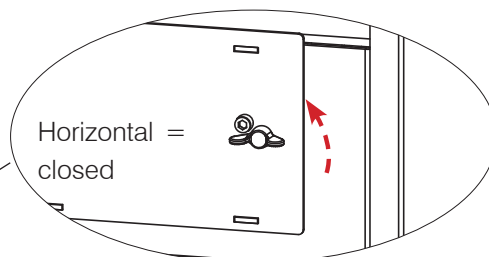
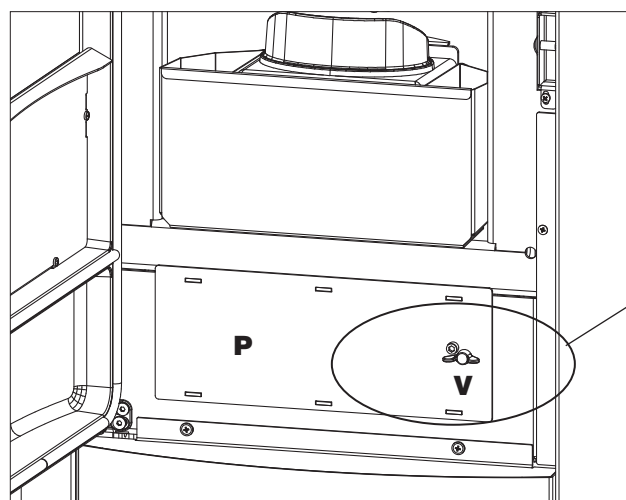

Make sure you have correctly repositioned the deflector after cleaning, it should be properly horizontal and inside the two screws. Reposition the deflector after vacuuming.

Remove the deflector and vacuum clean. Put back in position with care by placing it in its housing.

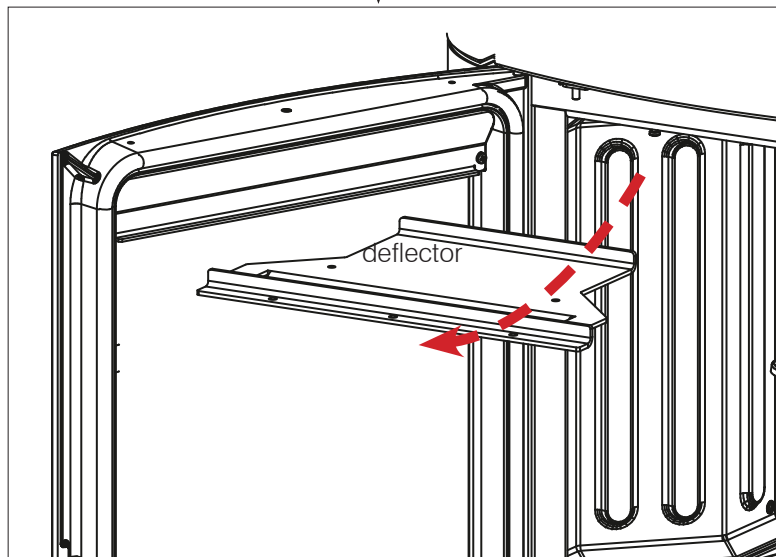
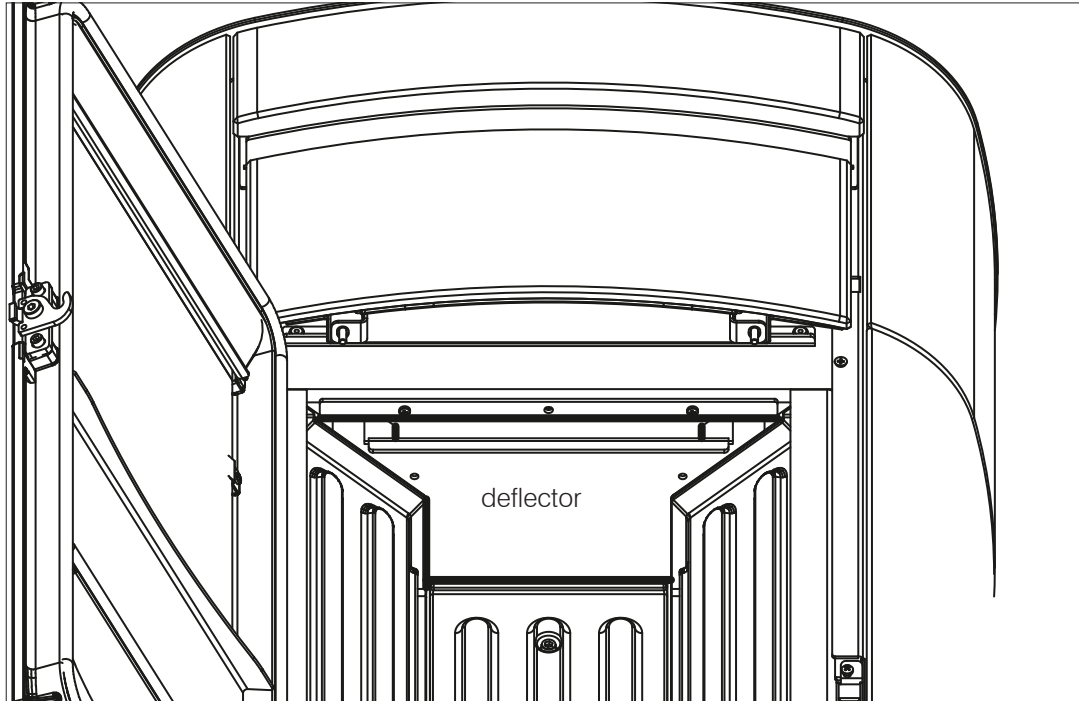

SEASONAL MAINTENANCE

(to be carried out by the technical assistance centre)

This consists in cleaning the stove inside and out.

If the product is used intensively, we recommend cleaning the smoke duct and flue every 3 months.

You should clean the chimney system at least once a year (check local regulations for details).

If you fail to regularly clean and inspect the system, there is an increased risk of the chimney pot catching fire.

We recommend against using compressed air to clean the combustion air inlet.

SUMMER SHUTDOWN

During the period of disuse, keep the stoves doors, hatches and lids closed.

We recommend emptying out the pellet tank. Place the package of dessicating salts inside the combustion chamber.

SPARE PARTS

for any spare parts, contact your reseller or technician. Using non-original spare parts may damage the appliance and relieves Edilkamin of all liability for damage resulting there from.

Do not make unauthorised modifications

DISPOSAL

At the end of its service life, dispose of the product as required by regulations.



In accordance with art. 26 of Legislative Decree no. 49 of 14th March 2014, "Implementation of Directive 2012/19/UE on the disposal of electrical and electronic devices (RAEE)".

The crossed-out dustbin symbol displayed on equipment or its packaging indicates that the product at the end of its life must be collected separately from other waste.

At the end of its useful life, the user should therefore deliver the product to a suitable local sorted collection centre for electrical and electronic devices.

Sorted collection for recycling, treatment and environmentally compatible scrapping contributes to the prevention of negative effects on the environment and health, and promotes the re-use and recycling of the materials of which the equipment is made.

If problems occur, the product shuts itself off automatically.

The display will show the reason (see below).

Do not disconnect from the power supply.

To start the product up again, allow the shutdown procedure to complete, then press the remote control's ON/OFF button or the simplified ignition button.

Before starting the product up again, check the reason for the shutdown and CLEAN THE GRATE.

The product is equipped with safety but, if the grate is not cleaned regularly as explained above, ignition may involve a small detonation. If white smoke forms in the combustion chamber for a long time, disconnect the mains supply and wait 30 minutes before opening the door and emptying out the grate.

SHUTDOWN MESSAGES AND THEIR SOLUTIONS:

MESSAGE	PROBLEM	SOLUTION
H01	displays when the combustion air intake is below the set level	<ul style="list-style-type: none"> • Check that the combustion chamber door is closed • Check the regular maintenance of the stove • Check that smoke discharge and combustion air ducts are clean.
H02	displays when the logic board is not detecting the right smoke fan speed	<ul style="list-style-type: none"> • Contact the technician
H03	displays when the thermocouple detects a smoke temperature lower than the set value and interprets this as the absence of flame	<ul style="list-style-type: none"> • Check that there are pellets in the tank • Contact the technician
H04	displays when ignition times out unsuccessfully	<p>There are two possibilities:</p> <p>NO flame:</p> <ul style="list-style-type: none"> • Check that the grate is seated properly and is clean • Check that there are pellets in the tank and grate • Use a piece of solid paraffin to light the stove (contact the technician first) <p>Flame present:</p> <ul style="list-style-type: none"> • Contact the technician
H05	Shut down due to air flow rate sensor breakage	<ul style="list-style-type: none"> • Contact the technician
H06	displays when the logic board determines that the smoke thermocouple is broken or disconnected	Contact the technician

MESSAGE	PROBLEM	SOLUTION
H07	Shut-down due to exceeding maximum smoke temperature.	<ul style="list-style-type: none"> • Check the type of pellet (contact the technician if in doubt) • contact the technician
H08	Switching OFF due to excessive overheating of the product	<ul style="list-style-type: none"> • see H07
H09	Shut-down due to gearmotor failure.	<ul style="list-style-type: none"> • Contact the technician
H10	Switching OFF due to circuit board overheating	<ul style="list-style-type: none"> • Contact the technician
H11	Switching OFF due to the intervention of the safety pressure switch.	<ul style="list-style-type: none"> • Ensure the stove and flue are clean • Contact the technician
H12	Room temperature probe failure. The product is operating in manual mode.	<ul style="list-style-type: none"> • Contact the technician

MESSAGES WHICH DO NOT SHUT THE STOVE DOWN, BUT ARE SIMPLY WARNINGS

LOW REMOTE CONTROL BATTERY LEVEL:

The battery symbol will appear on the remote control display if the battery is low.

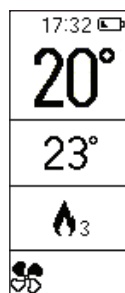

MAINTENANCE:

A wrench symbol is shown on the display after 2000 hours of operation.

The product is working, but it must be serviced by an authorised Edilkamin technician.

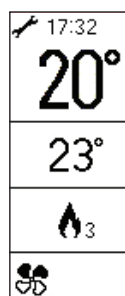



EDILKAMIN
TECNOLOGIA DEL FUOCO

www.edilkamin.com